



# ISOCARP

Knowledge for better Cities

## *Howard Smith Wharves*

**INNER CITY REJUVENATION AND URBAN CONNECTIVITY**

**YOUNG PLANNING PROFESSIONALS WORKSHOP | Brisbane | Australia | 26<sup>th</sup> - 30<sup>th</sup> September 2013**

**Organized as a part of 49<sup>th</sup> Congress of the International Society of city and Regional Planners**



**ISOCARP**  
International Society of City and Regional Planners

<i>ORGANIZATION</i>	2
<i>WORKSHOP BRIEF - YOUNG PLANNING PROFESSIONALS WORKSHOP</i>	5
<i>Introduction</i>	5
<i>YPP workshop as a part of ISOCARP activities</i>	7
<i>Nature of the YPP workshop</i>	7
<i>About Brisbane</i>	9
<i>Definition of planning situation</i>	11
<i>THE TEAM'S TACTICS</i>	12
<i>THEME</i>	12
<i>PROCESS</i>	12
<i>SWOT</i>	22
<i>OUR SHARED VISION</i>	23
<i>SCENARIO 1: THE CLIFF</i>	26
<i>SCENARIO 2: OXLEY WHARVES</i>	34
<i>SCENARIO 3: THE WHARVES</i>	42
<i>SCENARIO 4: HSW ECOTONES</i>	48
<i>THE EXHIBITION POSTERS</i>	52
<i>YPP PHOTO REPORT</i>	57
<i>WORKING DAYS</i>	57
<i>AT THE CONGRESS</i>	64
<i>The opening plenary</i>	64
<i>At the exhibition</i>	65
<i>The Gala Dinner – certificates and awards to ypp's</i>	66
<i>G'day mates. Cheers!</i>	67



## ORGANIZATION

This report was organised by the Coordination Team and Inês Moreira, with the collaboration of the participants involved. Contents were kindly shared and/or produced in the course of the workshop by participant.

*Young Planning Professionals Vice-President: Piotr Lorens*

*ISOCARP workshop coordinators:*

Sofia Morgado (Senior Workshop Coordinator) • Zeynep Gunay (Junior Workshop Coordinator) • Laura Gannon (Local Workshop Coordinator) • Piotr Lorens (Vice President for Young Planning Professionals, ISOCARP) • John Minnery (Queensland University – Head of LOC)

*Workshop participants*

The young planning professionals' team included:

- The international YPPs selected by ISOCARP and
- Local YPPs from Queensland selected by the LOC.

Anna Vladimirova • Arif Chohan • Bij Borja • Caitlin Pozzi • Daniele Vettorato • Ekaterina Meltcova • Ekaterina Starodubtseva • Evgenia Kolesova • Holly Williams • Inês Moreira • Jemima Hutch • Jess Carmichael • Katherine McAulay • Kerem Yavuz Arslanli • Luis Rodolfo Garrido Reyes • Melissa Anna Murphy • Meredith Hartigan • Michelle Willemse • Oluwafemi Olajide • Peter Gezik • Sarah Everson • Sławomir Ledwoń • Sophie Lam • Tristan Miles • Yuri Torres • Shan He

*Opening Lecture*

*River Waterfronts - Urban Celebrations* by Amos Brandeis, Keynote speaker of the Congress.

*Special Acknowledgments*

Gaby Kurth, ISOCARP  
BBC - Brisbane City Council and Howards Smith Wharves staff



Opening Lecture at the Theatre, BBC-Brisbane City Council, Brisbane, 26<sup>th</sup> September.



## Schedule

	SEPTEMBER	Friday	Saturday	Sunday	Monday	OCTOBER
	26	27	28	29	30	1
	YPP's Workshop					Conference
	1	2	3	4	5	6
MAIN FOCUS OF THE DAY	INTRODUCTION	FIELDWORK/1 <sup>st</sup> APPROACH	DEVELOPMENT/1 <sup>st</sup> DEBATE	DEVELOPMENT	PRESENTATION / EXHIBITION	PRESENTATION DAY
09.00		walk to Brisbane CC	Studio work	Local level detailed	Final materials	Opening plenary
10.00		Icebreaking HSW Workshop Project				Welcome(s)
		break				break
11.00		Tour of project area	Activities and outputs Brisbane CC (tbc) Focus packages	Studio work	Final materials	Keynotes; YPP
12.00						Presentation
13.00		lunch				lunch
14.00		Recap and Debate General Brainstorming	Studio work	Studio work	Final materials	[cfr Conference Schedule]
15.00						
		break				
16.00		Vision, Goals and Strategic Priorities	1 <sup>st</sup> Debate	Work check	Check and Amendments, etc.	
17.00		Main lines of development Regional to City levels	Dinner and Riverfire Event			
18.00	dinner					
19.00	Official welcome	Studio work		Project Achievables	Close of YPP Workshop	
20.00	Introduction Brisbane YPP Workshop			Previous YPP WS	Final details	
21.00	Amos Brandeis			Group debate on outcomes		

## WORKSHOP BRIEF - YOUNG PLANNING PROFESSIONALS WORKSHOP

[From the brochure organised for the workshop available at [www.isocarp.org](http://www.isocarp.org)]

### **Introduction**

*The workshop is a part of 49th annual ISOCARP congress which is hosted by the City of Brisbane, Australia. It is intended to function as a platform for Young Planning Professionals (YPPs) from various parts of the world to further associate with modern planning principles and emerging ways of thinking. At the same time, the international workshop delegates will be joined by a number of Australian YPPs. The workshop will provide all participants with the opportunity for exposure to different schools of thought and planning techniques used across the world.*

*The topic of 2013 annual workshop is “Howard Smith Wharves: Inner City Rejuvenation and Urban Connectivity” and deals with the future of one of the most important parts of the Brisbane city center – a riverside precinct comprising heritage-listed industrial buildings which remain one of the last surviving connections to Brisbane’s development history. The Howard Smith Wharves, constructed in the 1930’s, have continued to languish since the Port of Brisbane was established at the mouth of the Brisbane River, the gateway to Moreton Bay and the Pacific Ocean. As a result, much of Brisbane’s river-dependent industries relocated to the Port of Brisbane, leaving the Howard Smith Wharves to deteriorate over the years. It is important to remember that Brisbane is a newer world-city and its history only dates back to the early 1800’s which is quite distinct from other older cities around the world. Hence the value of protecting these wharves and ensuring their enduring value can be appreciated by future generations.*

*Despite the value of this very important precinct to the City of Brisbane, its abandonment over recent years has effectively formed a significant barrier between the city and the Brisbane River, a river which is celebrated and enjoyed*



An aerial photograph of Brisbane, Australia, showing the city center, the Brisbane River, and the Storey Bridge. The image is faded and serves as a background for the text.

*by the people of Brisbane. It has also contributed to the functional and aesthetic degradation of a potentially key urban waterfront area.*

*Therefore, this workshop will ask YPPs to propose new solutions for this city-river frontier as well as its connection with other significant places and spaces which surround it. These solutions must be effective, efficient, budget conscious and functional. The specific design problems will focus on the redesign of the public space below the Storey Bridge and its connectivity to surrounding locations. The primary constraint will be the retention of the existing heritage-listed buildings. You will be asked to focus on new opportunities for the development of an attractive and functional waterfront public space in this location.*

*A detailed information pack will be provided to you within the next few weeks which will include photographs, web links, Council documents include planning instruments, policies and strategies and the heritage conservation management plan. You will be expected to read this material prior to your arrival in Brisbane. The following maps and photographs depict the location and present situation of the site.*

*In terms of objectives and desired results, the workshop will function as an opportunity to provide the municipal administration of Brisbane, the Brisbane City Council, with fresh and innovative ideas regarding the future use and development of this key area of the city center.*

*These ideas can be further elaborated upon in conjunction with Brisbane City Council and potentially included in revised local planning instruments including the Brisbane City Plan and City Center Master Plan. Also, the workshop results may be of potential interest to key stakeholders, including Queensland University of Technology, the Queensland State Government and public and private infrastructure providers.*

*In addition to the practical outcomes of the workshop exercise, its results may also contribute to the wider congress discussions, as the topic is strongly associated with the Congress theme of 'planning frontiers'.*

### ***YPP workshop as a part of ISOCARP activities***

*The Young Planning Professionals Program was initiated in 1991 in order to provide unique opportunities to YPPs to share their knowledge, skills and experiences in an attempt to resolve complex and multi-dimensional planning issues. Since then, the YPP Program has become a crucial component of ISOCARP's dedication to the promotion and enhancement of the planning profession. The objective is to provide emerging professionals with an opportunity to work in a multi-cultural setting and share their experiences.*

*The first Young Planning Professionals' Workshop took place at the 26th ISOCARP Congress in*

*Guadalajara, Mexico (1991). Since then, senior members of ISOCARP have happily – and at times perhaps a little enviously – observed the competition for admission to the workshop, the creative spirit of the workshop itself, and the enthusiastic response of the participants. The YPP workshop has become a source of meaningful debate, new ideas and rejuvenation for the Society. It is now not only a unique opportunity for young planning professionals and postgraduate students from around the world to meet and exchange technical and scientific knowledge, but also a basis for making life-long friends.*

### ***Nature of the YPP workshop***

*YPP Workshops bring together young planners from all parts of the world. The workshops are brief, but very intense, brainstorming planning and design exercises in which our young colleagues work on real-life planning problems in the host city in an area defined by the local authority or university departments.*



An aerial photograph of a city, likely London, showing a river (the River Thames) flowing through it. A large bridge (Tower Bridge) is visible on the right side of the image. The city is densely packed with buildings and green spaces. The image is used as a background for the text.

*The YPP workshop has its own specific theme which is related to the main Congress theme. The theme relates to a specific area and/or project. The workshop is hands-on and seeks to establish solid working relationships between young professionals from all parts of the world who together seek final findings and results in a very short period of time. Over a concentrated period of four days, the YPPs will work in closely-knit international teams, exchanging ideas and learning from each other. The workshop, thus, provides a synergetic platform where new ideas and creative solutions to complex and multifaceted urban issues are produced. The tangible results are then presented at the main congress, are published in a Workshop Report, both on the ISOCARP website and on CD. The intangible ones, however, stay*

*in the hearts and minds of the participant YPPs, who not only learn from each other but make life-long friends. Therefore, YPP Workshops are brief-but-intense brainstorming and design exercises that resemble what are commonly known as 'charrettes'.*

*Another benefit of the YPP Workshop is related to the quality of the new ideas, concepts or proposals that are prepared and presented. The Young Planning Professionals are required to defend their ideas in front of a critical jury, the participants of the annual congress. Thus, the working teams have to prepare a well-rehearsed presentation that frequently catches the special attention of the planning authorities. The host Local Authority or Planning Agency usually welcomes the fresh ideas that arise from the Workshops. Sometimes these ideas and inputs have even been used as inputs in their own strategies for the study area.*



## **About Brisbane**

*Brisbane is the capital city of the State of Queensland, one of six States and two Territories of Australia and located in the beautiful sub-tropics. It remains at the heart of one of Australia's fastest growing regions, well known for its natural beauty and wildlife, world-class tourism attractions and very attractive climate. It has a metropolitan area spanning almost 6,000 km<sup>2</sup> and is home to just over 2 million people. It is the third most populous city in Australia, behind Sydney and Melbourne.*

*The land upon which Brisbane was established was traditionally occupied by the Jagera and Turrbal Aboriginal people who remain the traditional owners of the land. European settlement first occurred in 1823 following previous exploration efforts by Matthew Flinders in 1799.*

*Brisbane took its name from Sir Thomas Brisbane, a British soldier who travelled to Australia as part of the English Military which accompanied the initial convicts. Sir Thomas Brisbane was Governor of New South Wales (a separate State of Australia) at the time Brisbane was named.*

*Brisbane originally functioned as a penal colony for convicts sent from Sydney.*

*Fast forward to 2013 and Brisbane is the most welcoming and friendly city in Australia! In fact, in 2012 Brisbane was named in the top 7 most livable cities in the world at the prestigious Lee Kuan Yew World City Prize. It was the only Australian city named as a finalist for this prize which recognizes excellence in urban design, governance and innovation.*

*The City of Brisbane is partly established on the Brisbane River flood plain and has subsequently endured a number of disastrous flood events since its original settlement, the most recent being in 2011. Over time however and with the assistance of good planning, Brisbane's flood resilience continues to grow. Whilst we may not be able to prevent flooding, we can plan for it.*





*To this end, Brisbane maintains a very strong natural disaster prevention mindset which has translated into many State and local planning instruments.*

*Despite the flood risk sometimes posed by the Brisbane River, Brisbane residents continue to enjoy and celebrate the river upon which the city is located. In fact, it plays a central role in the annual Brisbane Festival, formerly 'Riverfestival', which in 2013 will take place between September 8 and 29. In recent years, a number of government projects have aimed to increase public access and participation in an around the Brisbane River, considered to be the 'lifeblood' of the city.*

*Brisbane accommodates the State Parliament, maintains the central business operations for a number of major national and international organisations and businesses. As with any great capital city, Brisbane includes a diverse range of architecture and public spaces. Buildings and spaces of note (and worth a visit) include:*

- City Hall and King George Square*
- Customs House*
- Parliament House*
- ANZAC Square and Shrine of Remembrance*
- Queen Street Mall*
- Queensland Club*
- Roma Street Parklands*
- City Botanic Gardens*
- Southbank Parklands*
- Gallery of Modern Art*
- Queensland Performing Arts Centre*
- Teneriffe Woolstores (urban renewal precinct)*
- China Town*
- Brisbane Powerhouse*

### *Definition of planning situation*

*The Brisbane City Council is currently in the process of amending and revising the Brisbane City Center Master Plan as well as its critical planning instrument, the Brisbane City Plan (visit [www.brisbane.qld.gov.au](http://www.brisbane.qld.gov.au) and search 'City Centre Master Plan' and 'Draft Brisbane City Plan').*

*As part of preliminary consultation with the community, prior to the August release of the Draft City Centre Master Plan, much thought and design concepts have been developed for the Howard Smith Wharves area.*



*"The workshop headquarters" at the BCC-Brisbane City Council*



## THE TEAM'S TACTICS

Considering the theme and a diverse material collection to work upon, which has included cartography, documents on the site history, planning material by the BBC-Brisbane City Council, a site visit with the fundamental assistance of the technicians working on these issues would allow a more consistent view.

## THEME

The theme of the workshop is **“Howard Smith Wharves: Inner City Rejuvenation and Connectivity”**. This comes from the need of redefining the city development strategy in relation to the indicated area, which will reinforce its competitive position, strengthen the central part of the city and take advantage of the extension of an existing and well-established network of the city's public spaces. Rethinking the future of “Howard Smith Wharves” as one of the last surviving connections to Brisbane's development history:

- Rejuvenating the north bank
- Bridging the urban divide
- Creating connections
- Enduring the value of heritage as commons

## PROCESS

After a first presentation of the topic and a lecture on similar issues, by Amos Brandeis, the first full day of work started with a site visit. Technicians working in the Howards Smith wharves presented the site, its issues and potential interventions. The visit was of great value, especially from the ones coming

from abroad since they were able to put the site into perspective within the city of Brisbane and its river.

This allowed for a brainstorm and debates on the development of the tasks towards building what the Team later called “Our shared vision”.

After the site visit, a collective SWOT analysis and the definitions of scenarios allowed for the design of 4 approaches or scenarios each of which driven by a “Vision” or key-concept.

In order to fulfil the workshop’s objectives, three aspects – Vision, Goals, Strategic Priorities – framed a set of tasks per group: 1) strategic framework, 2) Program and Design, 3) Global contributions / expected impacts.

The workshop would later be translated in a presentation at the plenary session of the 49<sup>th</sup> ISOCARP Congress and the exhibition of its posters, at the event’s venue, RICC, Brisbane. A reviewed version of the outcomes (presentation, exhibition, report) form part of the workshop CD.

*(Following pictures: at the site with technical team)*













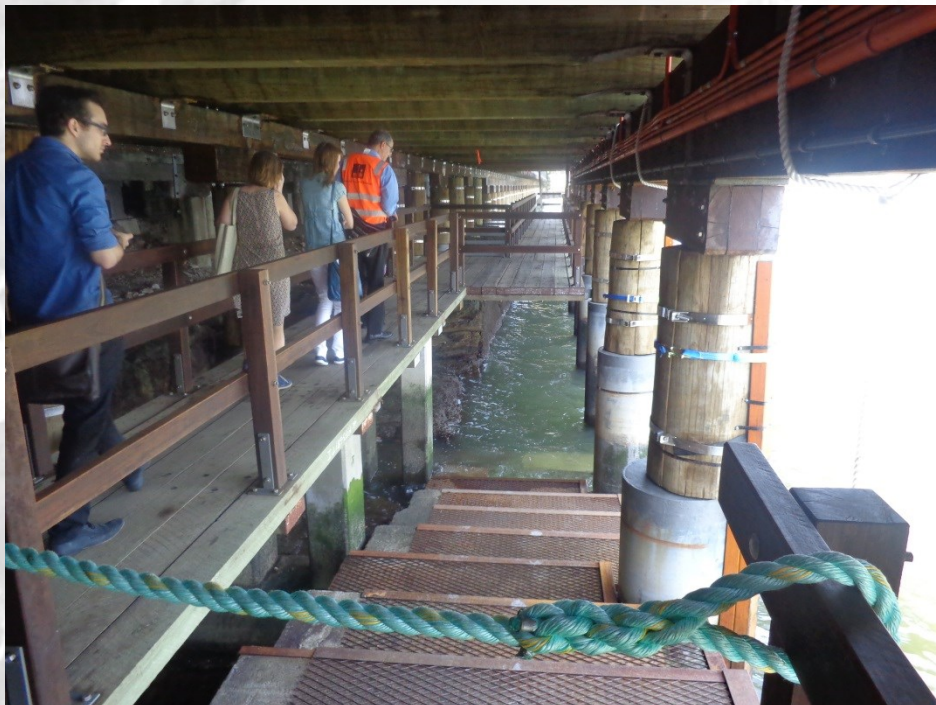













*Brainstorm session after site visit at BCC.*

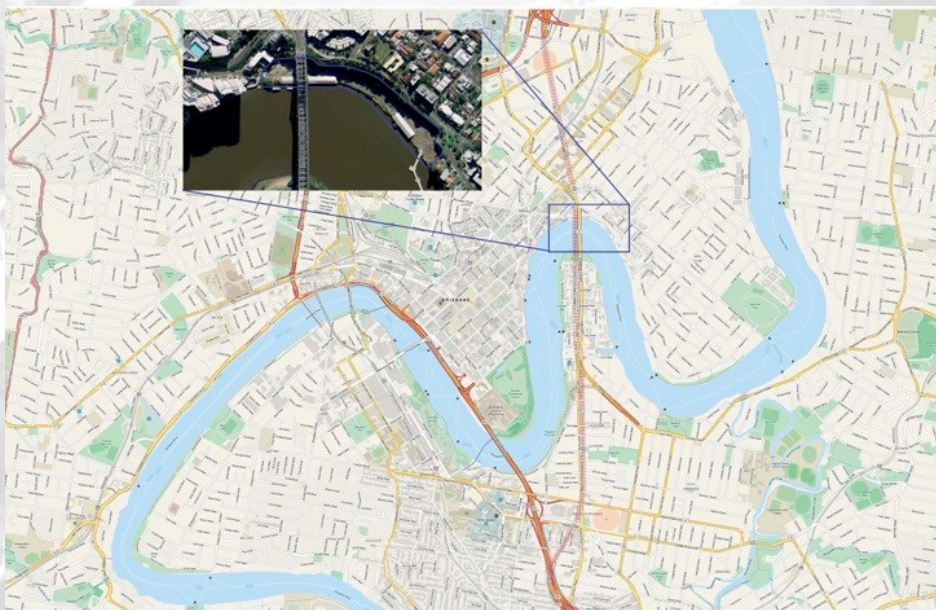



Howard Smith Wharves is a site recognised as a Brisbane landmark. The site is part of Brisbane's history and provides an insight into how Brisbane grew into the city it is today.

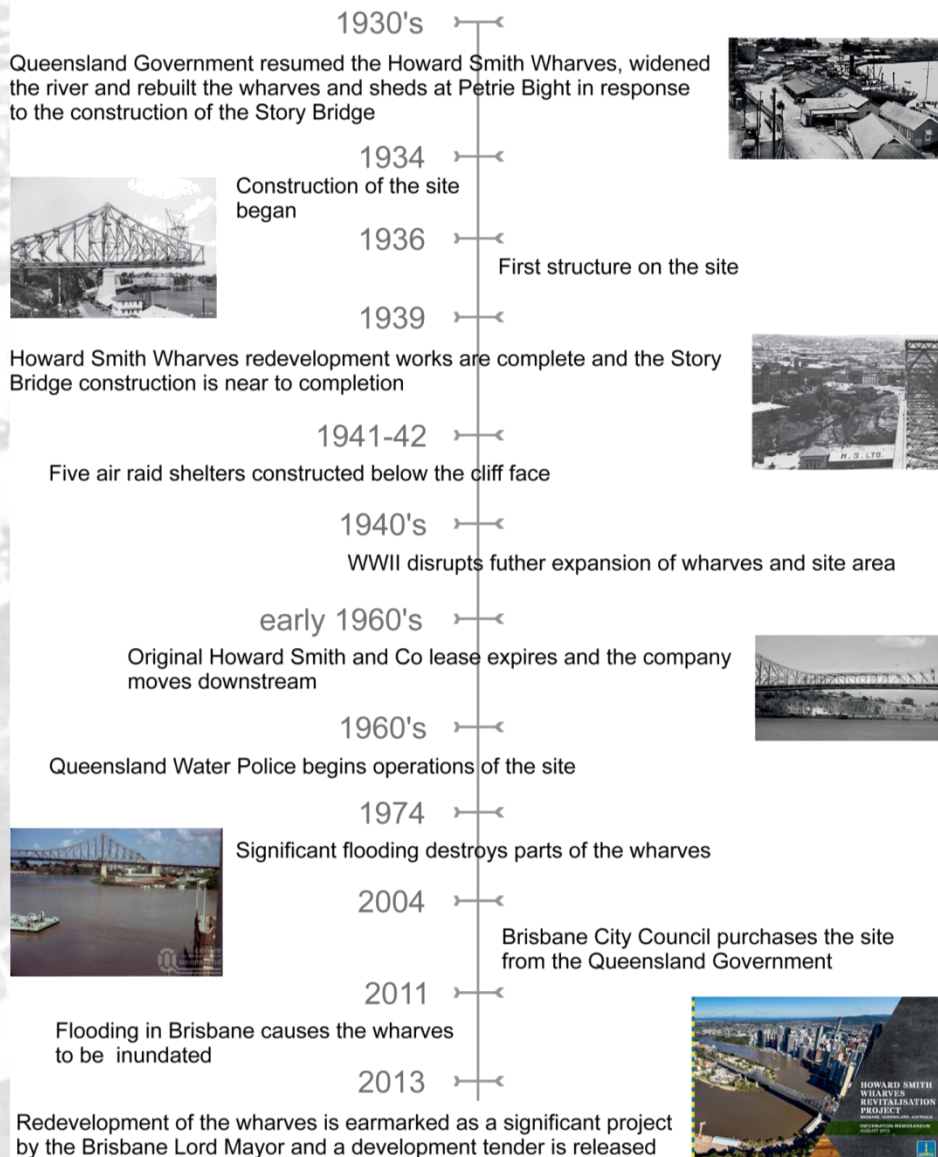

Site location and Howard Smith Wharves timeline (from poster Past, Present, Future, workshop's exhibition)

## INTRODUCTION



BRAINSTORMING  
DEBATES

**SITE VISIT  
SWOT  
SCENARIOS & TEAMS**

**VISION  
GOALS  
STRATEGIC PRIORITIES**

Strategic framework  
Programme & Design  
Global contributions / expected impacts

**POSTERS + PRESENTATION + REPORT**



## SWOT

### STRENGTHS

- Beautiful Views
- The River
- Symbolic Character
- Quiet Atmosphere
- Waterfront
- Public Transportation
- Story Bridge
- Historic Heritage



### WEAKNESSES

- No Access
- Steep Topography
- Small Area (Size)
- Unbuildable Soil
- Flood vulnerability
- Pedestrian Connectivity
- Car Parking

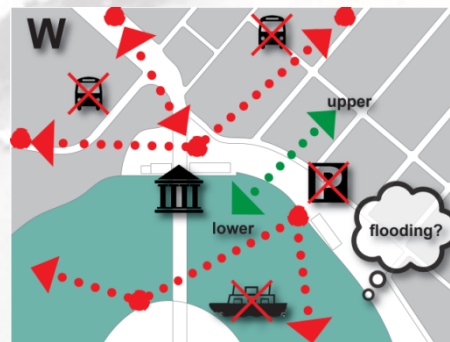

### OPPORTUNITIES

- Marketplace
- Increased Land Value
- Building/Structure on River
- Recreation
- Sporting Activities
- Improved Site Aesthetics
- Modern Technology



### THREATS

- Sea Level Rise
- Displacement of People in Public Housing
- Pollution in River

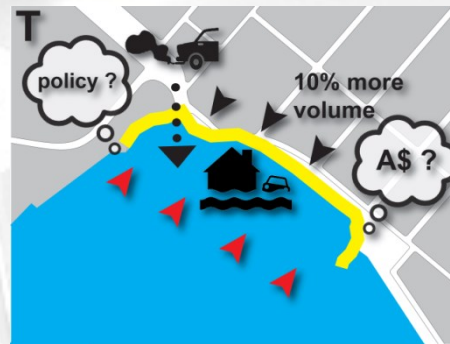

## OUR SHARED VISION

As referred, site and planning documents analysis, collective brainstorm and swot assessment, allowed for the identification of alternative scenarios, further developed by each of the 4 YPP's group. Findings and collective agendas were shared towards a steady set of outcomes.

### Scenario 1 - THE CLIFF

- To create a multi-use hub that includes a variety of uses throughout the day for a variety of user groups.
- To provide a diverse open space that is complementary to its landform, and provides diverse recreation opportunities.
- To become a unique, accessible riverfront destination that is both a breathing space and an exciting escape.
- To provide an active and lively space that is well-loved, safe and inclusive.

### Scenario 3 - THE WHARVES

- **Resilient**—Incorporating sub-tropical design for a resilient and responsive environment.
- **Unique Identity**—Capitalising on the unique heritage aspects and riverside location to create a destination.
- **Flexible**—Utilising multi-purpose spaces and innovative construction to create a flexible built form.
- **Inclusive**—Creating an inclusive urban environment with spaces for all.
- **Connected**—Increasing opportunities for transport options to connect to the surrounding environment.

### Scenario 2 - OXLEY WHARVES

- Ensure a balance between core project elements; people, economy, heritage and environment, while being sensitive to site features and constraints.
- Capture and enhance site's unique position next to the CBD while retaining a sense of escape.
- Create a welcoming escape from the intensity of the city for the community and its visitors.
- Embrace the river, the cliff and the site's heritage.
- Develop a niche economy that will contribute the wider Brisbane economy.
- Connect people.

### Scenario 4 – HSW ECOTONES

- **Connection 1 - Past and Present**—past and the present by combining new buildings with the historical Story Bridge pylons and re-purposed wharf sheds.
- **Connection 2 - CBD and Residential**—link the CBD end of the site to the residential-focused Valley end, connecting inner city Brisbane from the CBD through to New Farm via the site and the River walk.
- **Connection 3 - Upper and Lower**—An innovative spiral structure ('The Snail') will connect the cliff tops to the riverbank through the multi-use shed and amphitheatre.
- **Connection 4 - Land and Water**—An amphitheatre provides structured and casual connections between land and water.



An aerial photograph of a city, likely London, showing a river (the River Thames) winding through the urban landscape. A large, semi-transparent grey circle is overlaid on the center of the image, containing a list of project goals or values in white text. The background shows a mix of green spaces, buildings, and the river.

**Connecting people to place**  
**Capitalising on the riverside and  
city centre location**  
**Embracing the history and  
heritage**  
**Encouraging multiple uses for  
the open spaces**  
**Creating a welcoming and  
inclusive atmosphere**  
**Being a ‘one of a kind’**



## SCENARIO 1

# C L I F F

Ekaterina Meltcova (Russia)  
Kerem Yavuz Arslanli (Turkey)  
Michelle Willemse (Australia)  
Oluwafemi Olajide (Nigeria)  
Sarah Everson (Australia)  
Sławomir Ledwoń (Poland)  
Shan He (Australia-China)



An aerial photograph of the Brisbane Riverfront, showing the city skyline, the river, and the Howard Smith Wharves area. The image is used as a background for the document.

## **SCENARIO 1: THE CLIFF**

### *Strategic Analysis*

Howard Smith Wharves is located in close proximity to Brisbane's CBD and occupies a prime location along the Brisbane River. Listed on the Queensland State Heritage Register, the site is culturally and historically significant to the city of Brisbane. It has magnificent views to the CBD and along the River; however, the site is currently undeveloped and largely inaccessible. It has not been a site of significant activity since the 1960s. The site is also vulnerable to flooding, as was demonstrated in the January 2011 Brisbane floods, and when compared to other key Riverfront destinations in Brisbane (such as South Bank Parklands, Botanic Gardens and New Farm Park), the subject site currently exists as a deficiency in the network of Riverfront public spaces. To overcome these constraints, the unique visual and physical characteristics of the site need to be embraced and transformed into a world-class riverside destination.

### *Vision*

The Cliff project embraces the unique, natural role of the cliffs as a backdrop to the Howard Smith Wharves. The cliffs are a natural artwork, an adventure facility, a canvas for changing displays and provide the backbone for any development proposal on-site. The development of the Howard Smith Wharves site will be known as The Cliff. The Cliff is to become a key riverfront destination for Brisbane, which attracts a range of tourists for the unique experience it provides.

The Cliff is to provide a unique riverside destination that celebrates its heritage values and natural features whilst creating a multi-use space that is open and accessible to all.



## *Goals*

The goals of The Cliff are:

- To create a multi-use hub that includes a variety of uses throughout the day for a variety of user groups.
- To provide a diverse open space that is complementary to its landform, and provides diverse recreation opportunities.
- To become a unique, accessible riverfront destination that is both a breathing space and an exciting escape.
- To provide an active and lively space that is well-loved, safe and inclusive.

## *Strategic Framework*

The Strategic Framework contains four strategic outcomes that are based on the goals of the site.

### *Goal 1: Multi-Use Hub*

- The Cliff utilises its on-site heritage buildings for a range of permanent, semi-permanent and temporary activities for both residents and tourists to utilise.
- The Cliff provides world-class dining and café facilities that showcase local produce, while providing an enjoyable riverside experience.
- The Cliff provides tourist accommodation, community space and rentable space.
- The Cliff is a space for changing entertainment and activities that appeal to users of all ages and interests.

### *Goal 2: A Diverse Open Space*

- The Cliff embraces subtropical living, and encourages outdoor experiences.



- 
- The Cliff integrates with nature, respecting the natural features and landforms of the site.
  - The Cliff provides a place for respite, relaxation, adventure, play and exploration.
  - The Cliff responds to its flood-prone topography by providing flood-resilient infrastructure.

#### *Goal 3: Uniquely Connected*

- The Cliff is well-connected to its surrounds, with easy access to the city centre and a diversity of connections accessible for all abilities.
- The Cliff provides an out-of-city experience that maintains its vital connections to the city centre yet provides a unique destination in itself.
- The Cliff establishes itself as a well-loved niche for breath-taking views and diverse experiences.

#### *Goal 4: Active and Lively*

- The Cliff is a place for adventure, containing informal sport and recreation facilities and spaces that utilise the River and the cliff-face.
- The Cliff is a successful all-hours public space, and appropriately transitions throughout the day between family-friendly to hip and happening.
- The Cliff will have three precincts that create opportunities, avoid threats, minimise weaknesses, and capitalise on the strengths of the site. The precincts will respect and utilise the character of the site, the presence of the cliff-face, and the accessibility to the River.

#### *Precinct 1: Open Space*

Located at the eastern side of the site, the Open Space Precinct is casual and enjoyable place for relaxing and entertaining. The precinct uses natural elements in its landscaping, including rocks and logs for seating, as well as

An aerial photograph of a river flowing through a city. A large bridge with multiple spans crosses the river. The surrounding area is densely built up with various buildings and green spaces. The riverbank on the right shows some industrial or commercial structures. The overall scene is a mix of urban development and natural water features.

native plants. It contains an open lawn for informal recreation, which is a perfect location for viewing movies and displays on the proposed open-air screen. This screen will drape down the eastern face of the cliff on support structures, and can be packed away when not in use. Without heavily impeding upon the open space at ground level, new boutique accommodation will be provided. These will be unique, visually-impressive structures which have narrow supports that have minimal visual intrusion on the cliff-face, and fan out into five-star accommodation at the top. These structures will use strong elements of glass, which maximise viewing of the cliffs and reflect the landscape on its surface. To enhance public access to the accommodation and the precinct, there will be new pedestrian access from the top of the cliff-face. People will be able to walk directly onto one of the accommodation structures, where a new roof-top bar will become a trendy new destination for the city. The accommodation structures will be linked via a series of bridges, some in mid-air and some along the cliff-face, allowing people to touch the cliff safely and enjoy its natural beauty. The structures allow elevator access to ground floor, and a new pedestrian staircase will be provided from the eastern end of the site to allow access to and from the top of the cliffs.

### *Precinct 2: Active River Life*

The Active River Life Precinct promotes active recreation in the River, by the River, and along the cliff-face; it is the heart of The Cliff. It includes the space between heritage Buildings C and D, which are two heritage sheds already on-site. These heritage sheds are utilised to provide an array of temporary activities in-between more permanent uses. For instance, Building C could house an art museum/gallery that changes periodically to showcase new works from local and international artists. Space in-between these art displays could be rented for community events and parties. Building D could be the home of a weekly farmers' market, but could also be used for workshops, shows, and almost any other event. Pop-up bars and food stalls dotted around



An aerial photograph of a riverfront area, likely in Brisbane, Australia. The image shows a river flowing through a city, with a prominent cliff face on the right side. The riverfront is lined with buildings and greenery. The text is overlaid on the image, describing the development of the riverfront.

the Riverfront could complement the precinct as an active riverside location. The precinct also responds to local demand for more rock climbing facilities, by providing formal opportunity for rock climbing from the base of the cliffs. A new pedestrian ramp will connect Precinct 2 with the top of the cliff face.

The foreshore of Precinct 2 will utilise the River water to create small rock pools that are visually pleasing, allowing people to touch and interact with the water, and providing a complementary setting within the site. A select number of new licensed cafes and restaurants will be built in this precinct, allowing casual observation of the rock pools and River. The River Walk boardwalk will be extended along the width of The Cliff site, providing good connections for pedestrians and cyclists passing-by, or travelling to, the site. New jetties will extend from the River Walk, allowing people to walk further into the River corridor. Night-time projections from the Story Bridge could provide in-water holograms in the River that change regularly and attract people to walk along the jetties. A new CityCat or Ferry stop will be built along one of the jetties, creating improved public transport to the site to supports its redevelopment. People will be able to hire kayaks and canoes to explore the Brisbane River from one of the other jetties. A new, small-scale marina will also extend from the River Walk. This will contain space to house a tourist boat that operates from the site daily. There is space for a historical ship to be permanently docked here, providing a unique dining and entertainment facility that acknowledges the site's history as shipping wharves.

### *Precinct 3: Information Hub*

The Information Hub Precinct is where people can discover the activities at The Cliff, check-in to the site's accommodation, and learn about its historical significance. The precinct contains the administration of the site, as well as a small outdoor library, an internet lounge with free wi-fi and electronic device charging, a tourist information centre and reception for the site's accommodation. These uses will be housed in and around existing heritage

Buildings A and B. As this precinct is closest to the city's existing road network, a car park will be contained in this part of the site. The tourist information centre can sell tickets to the outdoor cinemas, historical ship, and tourist boat. The outdoor library provides the opportunity for people to borrow books on short-term loans, so that they may be read anywhere at The Cliff site.

### *Expected Impacts of The Cliff*

The redevelopment of the Howard Smith Wharves into The Cliff will drastically improve the attractiveness of the site. It will create a unique destination that presents a different experience than what other public Riverfront spaces in Brisbane offer. Its uniqueness will drive economic growth on-site and in the surrounding area. Both residents and visitors will find it a desirable space to recreate, socialise and enjoy multiple opportunities. By improving accessibility to the site, and providing space and facilities for activities of varying nature, The Cliff will provide something for all user groups and backgrounds. The Cliff will help Brisbane emerge as a new world city, improving tourism and stimulating the local economy. Once again, this historic site will be celebrated and embraced by many.

**THE CLIFF** is to provide a **unique riverside destination** that celebrates its **heritage values** and **natural features** whilst creating a **multi-use** space that is open and **accessible** to all.

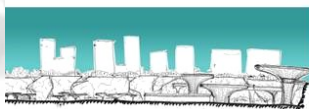



### precinct one: OPEN SPACE

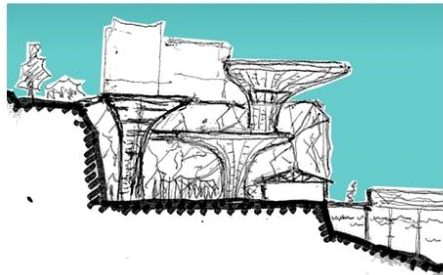

### precinct two: ACTIVE RIVER LIFE

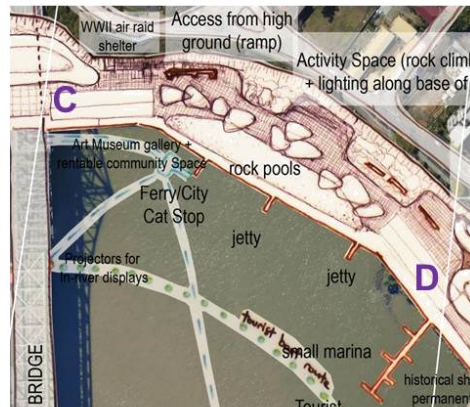

### precinct three: INFORMATION HUB

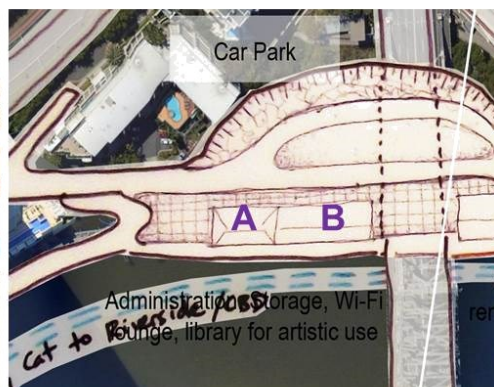





Arif Chohan (Australia - Pakistan)  
Evgenia Kolesova (Russia)  
Inês Lopes Moreira (Portugal)  
Yuri Torres (Brasil)  
Holly Williams (USA)  
Jemima Hutch (Australia)  
Sophie Lam (Australia)

*SCENARIO 2*

# OXLEY WHARVES



## **SCENARIO 2: OXLEY WHARVES**

### ***Vision and Wider themes***

Oxley Wharves will be a vibrant and well-connected place of transition between the city and the suburb that builds on the history, environment and physical characteristics of site. This link to the suburbs will support the city to function as part of an open space network, as an economic driver and as a place for the people. It will be a tribute to the river, its value and its potential.

### ***Objectives***

Oxley Wharves has been designed to:

- Ensure a balance between core project elements; people, economy, heritage and environment, while being sensitive to site features and constraints
- Capture and enhance site's unique position next to the CBD while retaining a sense of separation and escape
- Create a welcoming escape from the intensity of the city for the community and its visitors
- Embrace the river, the cliff and the site's heritage
- Develop a niche economy that will contribute to the wider Brisbane economy
- Connect people with places, spaces and facilities

### ***Design Concept***

The Oxley Wharves site has been designed to be an environment where people will experience a transition in space as they move through the site.

An aerial photograph of a city, likely Brisbane, showing a river flowing through it. The river is in the foreground, with a bridge crossing it. The city skyline is visible in the background, with various buildings and green spaces. The image is used as a background for the text.

People will transition from a faster paced, more active space at the western end of the site, to a slower open area at the eastern end. Oxley Wharves will celebrate the historical values of the site while providing an attractive place for people to slow down and experience the vitality and energy of the Brisbane River.

The concept has been formed by integrating the existing structures of historical significance with the environmental features of the site and new multi-functional structures. The site will incorporate a small three-storey boutique hotel with versatile outdoor spaces, while making the river and cliffs integral to the site's appeal.

The site will attract a wide range of people; whether they are visitors to Brisbane, or local community members. Opportunities will exist to partake in recreational activities, relax in attractive open spaces, revel in the history and artistic qualities of the site or be entertained in a variety of restaurants, bars and cafes. The site will be a key destination in the wider network of Brisbane open spaces, while also being connected to this network by a variety of transportation modes.

People will be compelled to visit Oxley Wharves to involve themselves the variety of experiences. These experiences will be developed through the destination of zones within the site. These zones are not bound by physical markers, but rather by experiences. These zones have been designed to illustrate the different paces of life; celebrating the transition from fast urban centre, to the calm suburban environment.

#### *The relation with the city*

Embracing the river as the backbone for the urban development of the city of Brisbane, the present Scenario for Oxley Wharves proposes an open space of fruition for the inhabitants of the city. The site represents a node in the network of open spaces located along the river, offering a singular identity



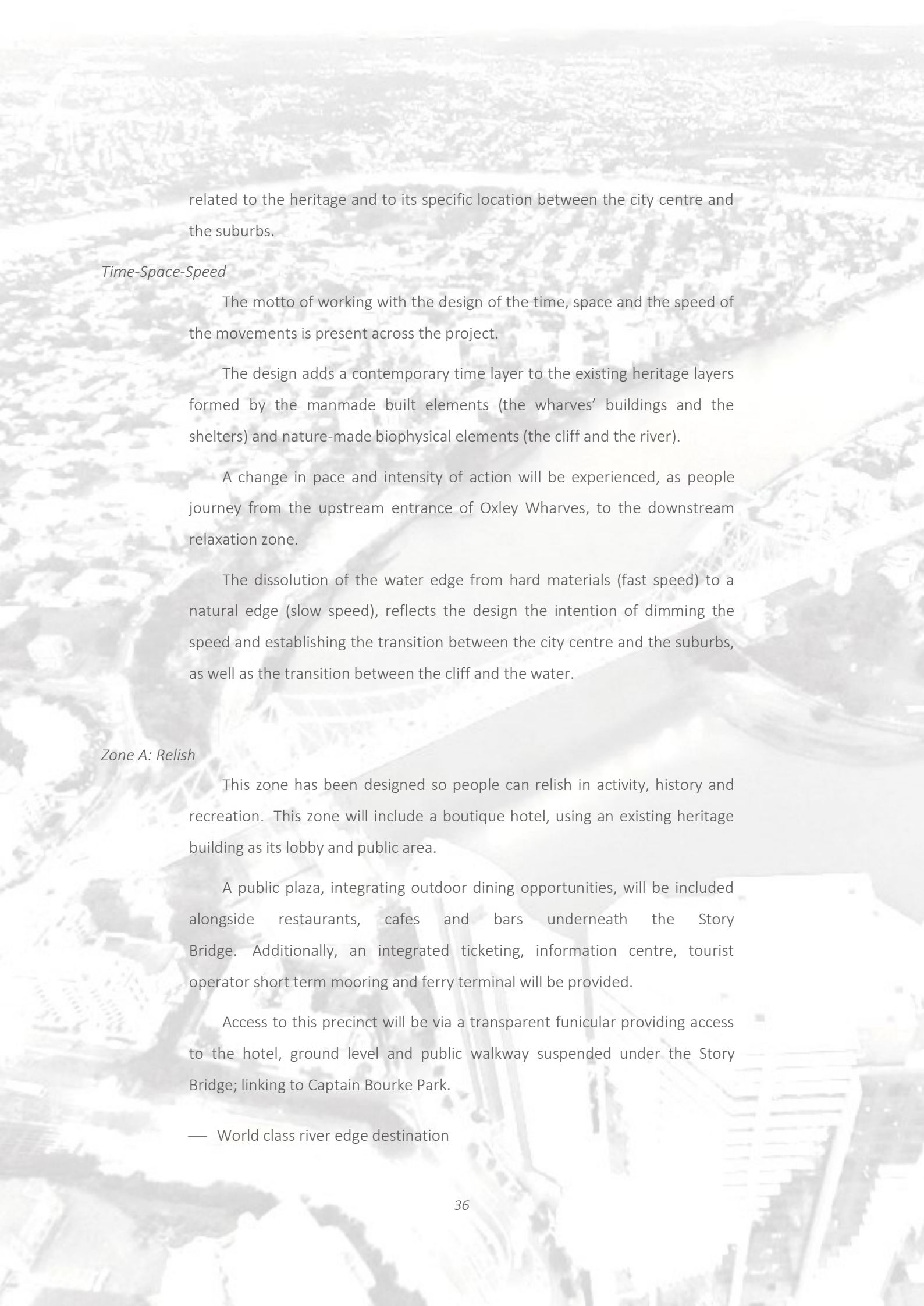

related to the heritage and to its specific location between the city centre and the suburbs.

### *Time-Space-Speed*

The motto of working with the design of the time, space and the speed of the movements is present across the project.

The design adds a contemporary time layer to the existing heritage layers formed by the manmade built elements (the wharves' buildings and the shelters) and nature-made biophysical elements (the cliff and the river).

A change in pace and intensity of action will be experienced, as people journey from the upstream entrance of Oxley Wharves, to the downstream relaxation zone.

The dissolution of the water edge from hard materials (fast speed) to a natural edge (slow speed), reflects the design the intention of dimming the speed and establishing the transition between the city centre and the suburbs, as well as the transition between the cliff and the water.

### *Zone A: Relish*

This zone has been designed so people can relish in activity, history and recreation. This zone will include a boutique hotel, using an existing heritage building as its lobby and public area.

A public plaza, integrating outdoor dining opportunities, will be included alongside restaurants, cafes and bars underneath the Story Bridge. Additionally, an integrated ticketing, information centre, tourist operator short term mooring and ferry terminal will be provided.

Access to this precinct will be via a transparent funicular providing access to the hotel, ground level and public walkway suspended under the Story Bridge; linking to Captain Bourke Park.

— World class river edge destination

- 
- An aerial photograph of a city, likely Sydney, showing a river (the Sydney Harbour Bridge area) and surrounding urban development. The image is faded and serves as a background for the text.
- Iconic entry to the site
  - A vibrant destination for people
  - Boutique short term accommodation
  - Mix of business, tourism and leisure

More commercial oriented, hotel, hotel reception (old building), hotel terrace, parking, plaza under the bridge (pillars like a big entrance) with cafes, elevated tram station, ticket booth/ citycat station and touristic fleet, observation platform hanged to the bridge and intermediate tram station.

#### *Zone B: Remember*

This zone has been designed to focus on remembering the past of the site. Linking from the public plaza, will be a pathway through the existing heritage building which will provide the experience of a journey through historical displays, artwork and references.

- Welcoming and accessible place for all
- Intelligent blend of natural, heritage and cutting edge features
- Attractive promenade integrating the heritage features of the site with recreational and entertainment uses
- Place to showcase the history, culture and art
- Place for people to eat, drink, chat, fun and relax

The heritage air raid shelters in the cliff will be incorporated into a themed playground, to ensure that the site's heritage can be enjoyed by people of all ages. This zone will include a small marina and a launch facility for kayaks and other recreational craft.

Enhancing the value of site's history by incorporating the warehouse as an exposition pavilion, embracing the shelters as potential playground zone, small marina and kayak spot.



An aerial photograph of a coastal area. A river flows through the center, bordered by steep cliffs. On the left, there are dense residential buildings. On the right, there are more industrial or commercial structures. The overall scene is a mix of urban development and natural landscape.

### *Zone C: Relax*

Relaxation and enjoyment has been the focus of this zone's design.

People will be able to enjoy the landscaped open space as well as use the multifunctional heritage building. This building will be complimented with outdoor shade sails, which is a tribute to the marine heritage of the site.

- Pleasant, relaxing and flexible open space
- Highlight the natural features of the cliffs and the river
- Comfortable and inviting space that will encourage people to stay and enjoy the features of the precinct
- Place to slow down and escape the pace of the city next door

The access to this site will be through a sensitively designed ramp along the cliff face; encouraging people to slow down and experience the views from and beauty of the cliffs from various angles.

Community-like space, open grass-like multipurpose field for family picnics, movie projections, relaxation, Zen zone, meditation, organic market

Relaxation and enjoyment has been the focus of this zone's design.

People will be able to enjoy the landscaped open space as well as use the multifunctional heritage building. This building will be complimented with outdoor shade sails, which is a tribute to the marine heritage of the site.

Access to this site will be through a sensitively designed ramp along the cliff face; encouraging people to slow down and experience the views from and beauty of the cliffs from various angles.

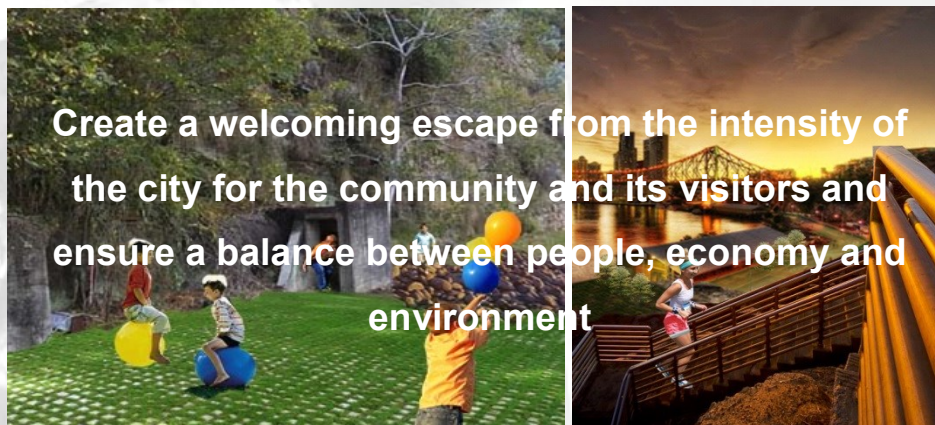
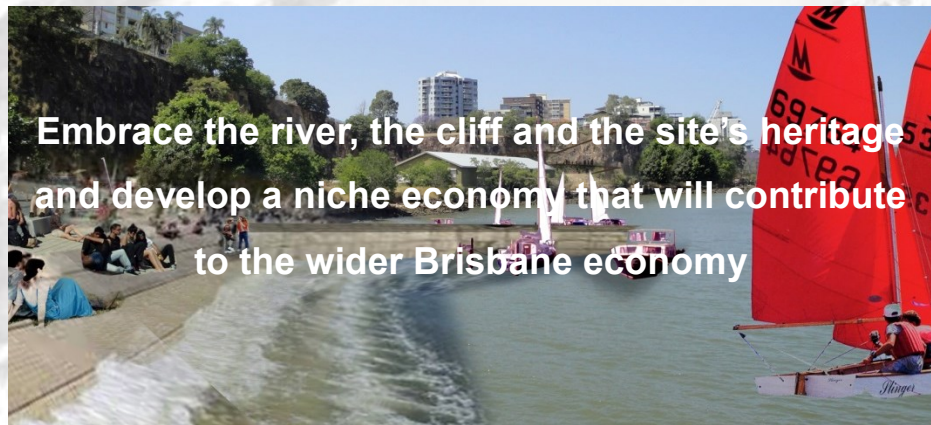
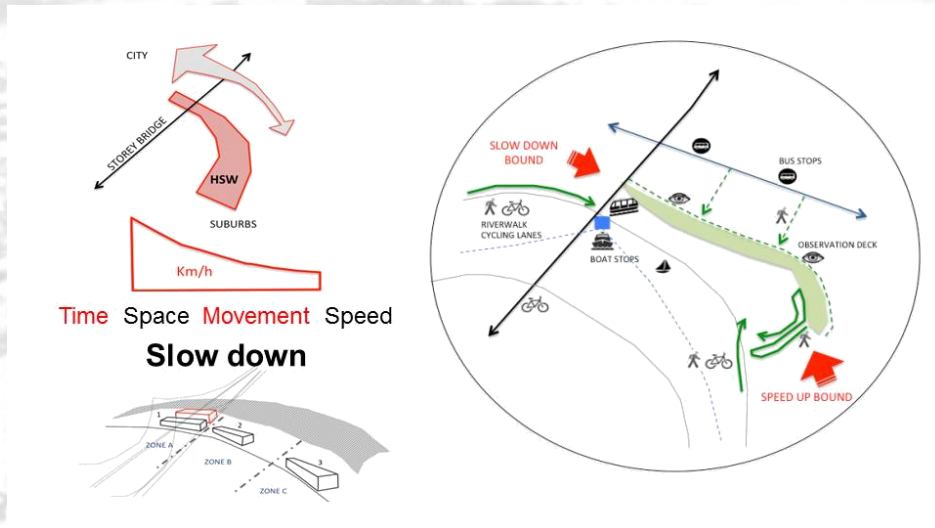



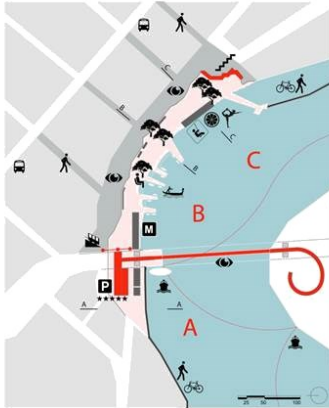

#### A. Relish

- A vibrant destination for people
- Boutique short term accommodation

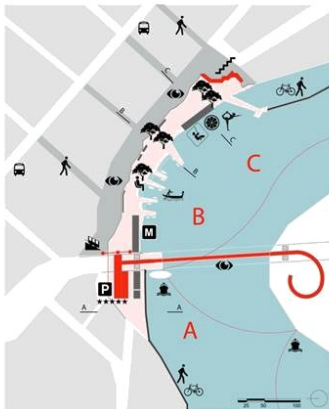
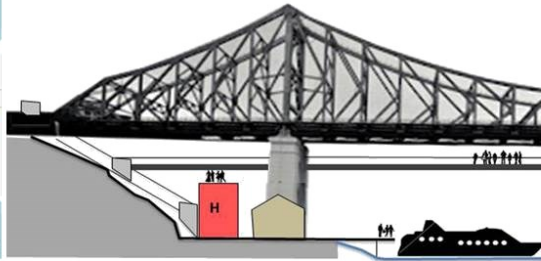

#### B. Remember

- A place to showcase history, culture and art
- A place for people to eat, drink and recreate

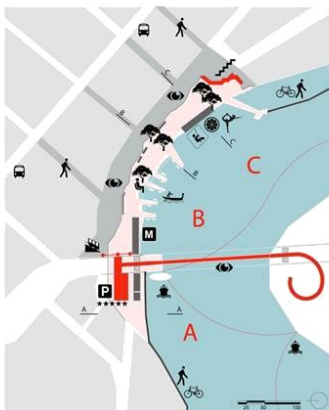
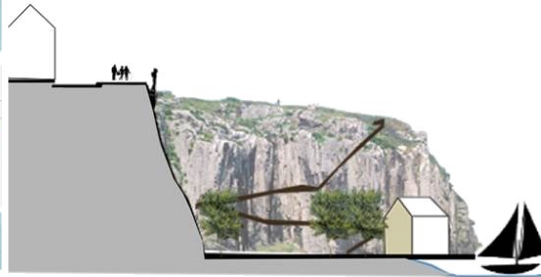

#### C. Relax

- Highlighting the natural features of the cliffs and river
- A place to slow down and escape the pace of the city

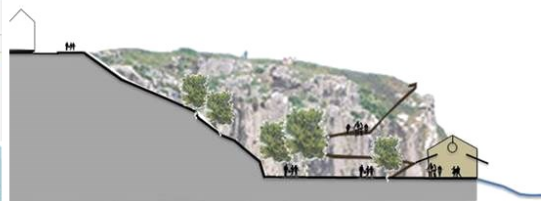



Caitlin Pozzi  
(Australia)  
Ekaterina  
Starodubtseva  
(Russia)  
Jess Carmichael  
(Australia)  
Melissa Anna Murphy  
(Norway - USA)  
Meredith Hartigan  
(Australia)  
Peter Gezik (Slovakia)

### SCENARIO 3

# THE WHARVES



An aerial photograph of a river flowing through an urban landscape. The river is in the center-right, with buildings and greenery on both banks. The image is faded to serve as a background for the text.

### SCENARIO 3: THE WHARVES

Resilience of nature – this proposal invites the flood in. Rather than design against the flood, program and buildings are envisioned to allow the flood to happen while mitigating damage. This is proposed through minimizing development and maximizing site sensitivity particularly at the ground level. The site is first considered as part of the larger systems of natural ecology in the city, and this proposal marks the potential for it to become a part of a future river remediation effort. Areas at the river's edge are planned to be treated as natural wetlands, bringing in local vegetation and beginning with low-tech landscape solutions to prevent site erosion and cleanse local water. These areas offer spaces where flora and fauna can meet the city, encouraging biodiversity. Boardwalks bridging these areas in the east of the site, and stairs down to the water throughout the site encourage human connections to - and remembrance of - the delicate ecosystems at play in the river.

New proposed buildings are further planned to be designed in harmony with the local climate – making use of natural air flow and shaded verandas recalls the key tenants of Queensland's traditional architecture, allowing opportunities for reinterpreting the vernacular.

Resilience on the site – through flexibility, ground floor spatial uses have been selected which can have a semi-permanent, packable nature. This would include food stalls, farmers and delicacy market booths, a function hall, parking and loading functions.

Resilience of culture – by maintaining the existing structures and adapting them to new use, the local industrial history is preserved and remembered. This aspect is reinforced by a museum to local industrial history proposed in Building. Going further than just preserving the buildings, the plan *connects* people and draws them in to experience the otherwise forgotten parcel of Brisbane. Connections from nearby residential areas, commuting routes such

as the river-walk and Storey Bridge, tourist boats, and limited car parking offer a variety of modes for people to reach the site.

Resilience of use – rather than developing the site only for tourists, this plan incorporates everyday uses for local people, to encourage a long-term sense of ownership in the site. At the East end, residents from the cliff tops are drawn down into the site through terraces where community gardens are proposed along with ease of site access with stairs and ramps. The skate-park/event venue area planned is another transformable use space that can attract local groups on the daily basis and citywide or even tourists on the occasional.

PLAYGROUND? An office building proposed over the parking garage for the site encourages daytime uses, where workers can make habit of eating lunch in the proposed restaurants, food hall, or market and vending stalls – or bring their own food and enjoy the open outdoor river seating. Café spaces in the morning can become pubs at night, farmers' markets of local produce can become craft markets or art exhibitions in the winter months, but the office uses, museum, and permanent food hall with restaurants will be permanent fixtures for the everyday. Social ecology is embraced by drawing a variety of people, not only making the space accessible to them, but providing functions that appeal to and across a variety of demographics.

## The Wharves: Vision

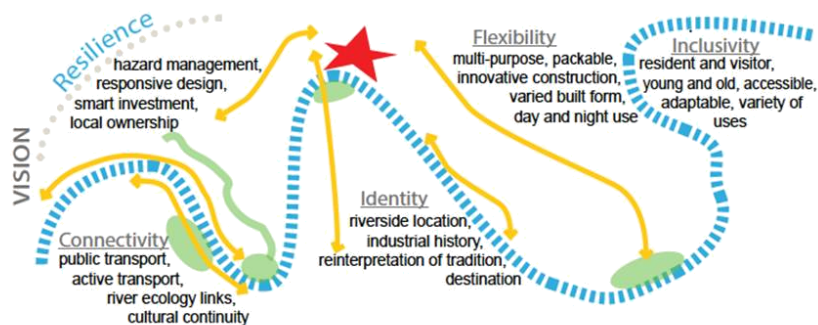



The Wharves: Vision

*RESILIENCE*



Brisbane Floods - 2011

The Wharves: Vision



The Wharves: Design Elements



'Queenslander' style boutique accommodation

The Wharves: Design Elements

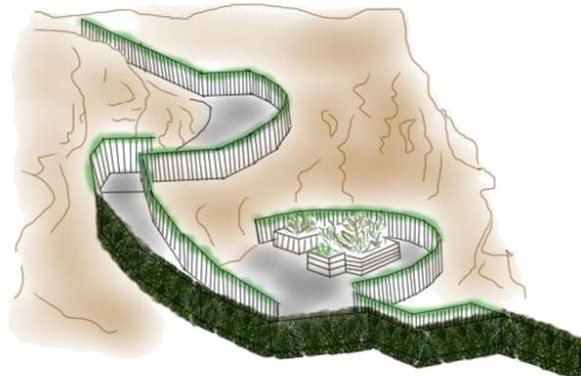

Cliff ramp access with community gardens

The Wharves: Design Elements

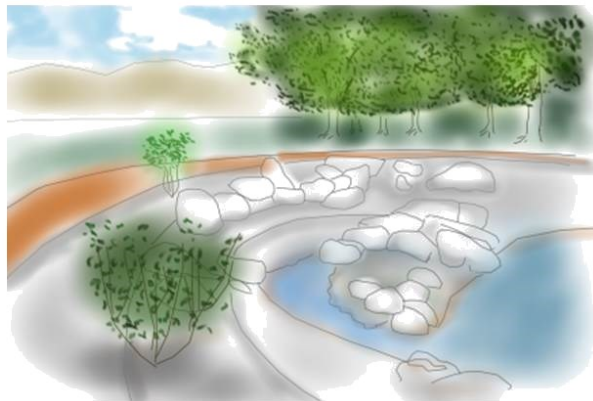

Pool and parkland area

The Wharves: Design Elements



Multi-purpose facility – skate park/event venue



## The Wharves: Design Elements



Adaptive re-use of heritage warehouses

## The Wharves: Design Elements



5 storey office building

## The Wharves: Opportunities

- One-of-a-kind
- Combining hazard management and resilient design
- Multi-purpose approach will be economically sustainable and attract a variety of users



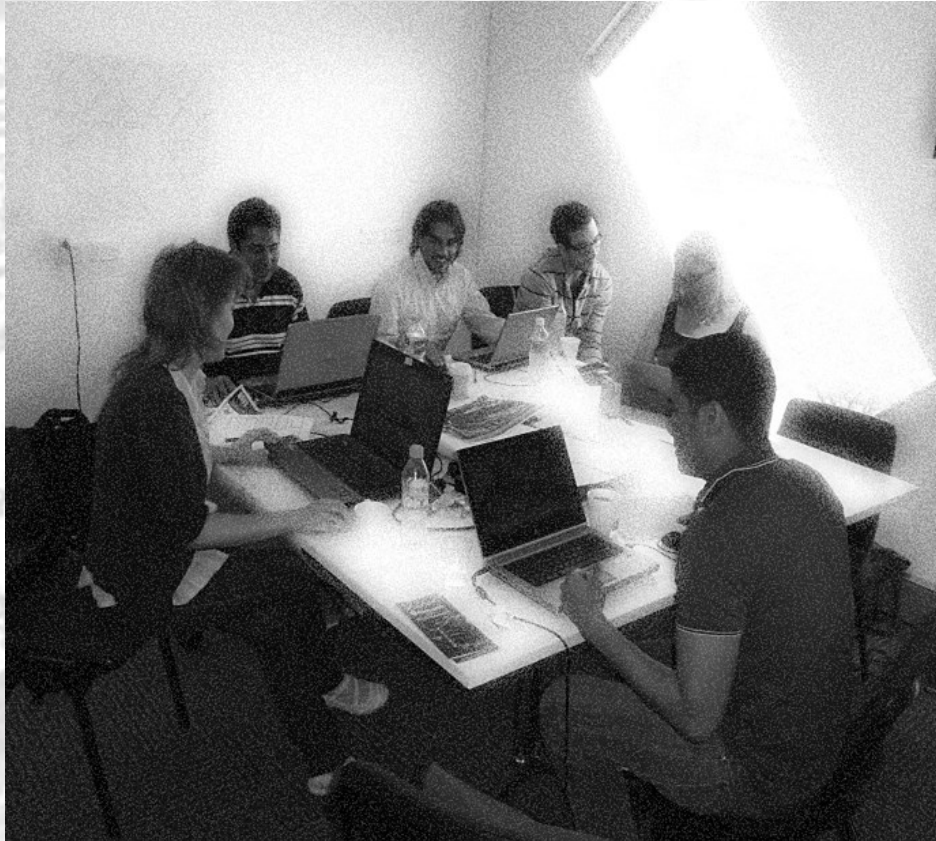

Anna Vladimirova (Russia)  
Bij Borja (Singapore - Philippines)  
Daniele Vettorato (Italy)  
Luis Rodolfo Garrido Reyes  
(Mexico)  
Katherine McAulay (Australia)

#### *SCENARIO 4*

# HSW ECOTONES



#### SCENARIO 4: HSW ECOTONES

The Howard Smith Wharves and the Story Bridge are iconic places of Brisbane city. Both are recognized by the most of the inhabitants, but the site doesn't have a plenty of active users. Also the meteorological risks like floods that damaged the river pad which had connected the CBD and Fortitude Valley through the wharves. The site has plenty of potential uses that can take advantage of the heritage protection, open areas, historic buildings, landscapes, connectivity opportunities.

By itself the site has an especial characteristic: it can be considered an *Ecotone*. An ecotone is a site placed in the transition of two or more environments or ecosystems; in this case we have the transition between the city and the river, the buildings and the natural environment.

The proposals of the group are to use this ecotone to connect not only environments, connecting the time PAST-PRESENT; connecting land uses CBD-RESIDENTIAL; connecting activities UPPER-GROUND levels, and LAND-WATER.

It's important to retrieve the value of historic buildings, generate healthy and safety open areas, a playground for disabled people and kids it's possible. Giving sufficient and secure tracks for pedestrians and no motorized transport like bikes, skates, kayak, etc. The iconic proposal for the site is the SNAIL, a building complex with snail shape who connects the top and the bottom of the cliff, this shape covered with green roofs and walls which going to be a complement of the cliff and not changing the landscape. The SNAIL would contain shopping, accommodation and recreational uses.

To connect and bring The Land to the Water the idea is build a Floating amphitheatre that the people can enjoy sitting in the riverside and for bringing the Water to the Land through a pool placed in the open area.

The intention is to enhance the heritage and iconic character of the site through the intensive and integral uses.



## HSW Ecotone Conceptual framework

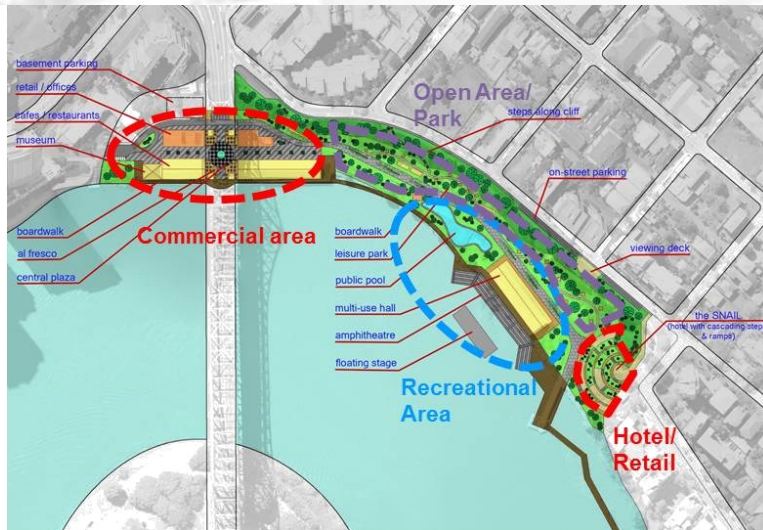

Past and Present



CBD and Residential



Upper and Lower

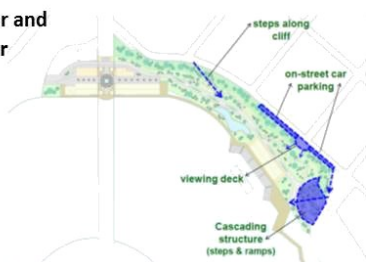

Land and Water













## THE EXHIBITION POSTERS



# ISOCARP

Knowledge for better Cities

### YOUNG PLANNING PROFESSIONALS WORKSHOP 2013

26-30th September Brisbane, Australia

The workshop is a part of 48th annual ISOCARP congress which is hosted by the City of Brisbane, Australia. It is intended to function as a platform for Young Planning Professionals (YPPs) from various parts of the world to further associate with modern planning principles and emerging ways of thinking. At the same time, the international workshop delegates will be joined by a number of Australian YPPs. The workshop will provide all participants with the opportunity for exposure to different schools of thought and planning techniques used across the world.

**THEME**

The theme of the workshop is "Howard Smith Wharves: Inner City Rejuvenation and Connectivity". This comes from the need of redefining the city development strategy in relation to the indicated area, which will reinforce its competitive position, strengthen the central part of the city and take advantage of the extension of an existing and well-established network of the city's public spaces.

**ORGANIZATION**

Sofia Morgado (Senior Workshop Coordinator) • Zeynep Garay (Junior Workshop Coordinator) • Laura Gannon (Local Workshop Coordinator) • Piotr Lorens (Vice President for Young Planning Professionals, ISOCARP) • John Minery (Queensland University – Head of LOC)

**PARTICIPANTS**

Anna Vladimirova • Arif Chohan • Bijl Boris • Caitlin Pozzi • Daniele Vettorato • Ekaterina Melnicova • Ekaterina Starodubtseva • Evgenia Kolesova • Holly Williams • Inés Moreira • Jenna Hatch • Jess Carmichael • Katherine McAulay • Karen Yavuz Arslanli • Luis Rodolfo Garrido Reyes • Melissa Anna Murphy • Meredith Hartigan • Michelle Willemse • Chawdell Clapton • Peter Goble • Sarah Evenden • Sawomir Ledwoch • Sophie Lam • Tristan Miles • Yuri Torres



International Society of City and Regional Planners | ISOCARP



# ISOCARP

Knowledge for better Cities

### HOWARD SMITH WHARVES

Inner city rejuvenation and urban connectivity

Young Planning Professionals Workshop 2013



**INTRODUCTION**

The topic of the 2013 ISOCARP Young Planning Professionals (YPP) workshop is "Howard Smith Wharves: Inner City Rejuvenation and Urban Connectivity", which focuses on the future of one of the most historically significant parts of Brisbane – a riverside precinct comprising heritage-listed buildings and landscape features that form one of the last surviving connections to Brisbane's historic past.



**PROCESS OF WORK**



Brisbane City Council has invited proposals from the development industry to revitalise the Howard Smith Wharves into a world-class riverfront destination. There is an identified need to reactivate and re-energise the wharf area into a place that is a vibrant, visible and unique riverfront destination that celebrates the cultural and lifestyle values of Brisbane.



**THE YPP WORKSHOP**

The ISOCARP YPP workshop is intended to function as a platform for YPPs from various parts of the world to enhance their knowledge of modern planning principles, improve their skills in strategic planning and practice new ways of thinking. For ISOCARP 2013, hosted in Brisbane, the international workshop delegates were joined by a number of local Australian delegates. The YPPs have been brought together to develop new recommendations to revitalise the Howard Smith Wharves into a unique and celebrated destination.



International Society of City and Regional Planners | ISOCARP



**ISOCARP**  
Knowledge for better Cities

## PAST. PRESENT. FUTURE

### Howard Smith Wharves



The Howard Smith Wharves is located on the northern side of the Brisbane River, under the Story Bridge. The site is 3.52 hectares in size and is one of the last remaining wharf sites in Brisbane. Its close proximity to various business, entertainment and cultural precincts within the city centre presents an exciting opportunity to create a distinctive and exciting place for the people.

Howard Smith Wharves is a site recognised as a Brisbane landmark. The site is part of Brisbane's history and provides an insight into how Brisbane grew into the city it is today.

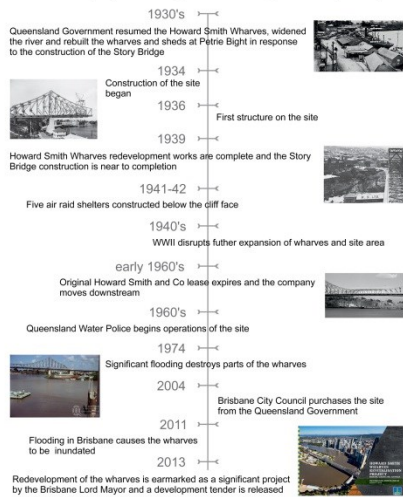

International Society of City and Regional Planners | ISOCARP



**ISOCARP**  
Knowledge for better Cities

## SWOT ANALYSIS

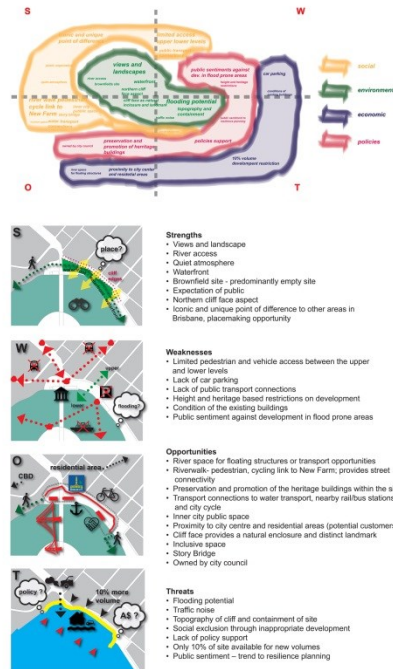

International Society of City and Regional Planners | ISOCARP





**ISOCARP**  
Knowledge for better Cities

## SCENARIO 1. THE CLIFF

Connected, Lively, Inclusive, Functional, Fun!

Karem Yavuz Arslanli, Sarah Everson, Shen He, Slavomir Lachner, Ekaterina Melnicova, Olawafemi Ojoide, Michelle Willemsse



### VISION

The Cliff is to provide a unique riverside destination that celebrates its heritage values and natural features whilst creating a multi-use space that is open and accessible to all.

### STRATEGIC FRAMEWORK

- Goal 1: Multi-Use Hub
- Goal 2: Diverse Open Space
- Goal 3: Uniquely Connected
- Goal 4: Active and Lively

The Cliff will have three precincts that will respect and utilise the character of the site, the presence of the cliff face, and the accessibility to the River: (1) Open Space, (2) Active River Life and (3) Information Hub.

### EXPECTED BENEFITS OF THE CLIFF

- Improved attractiveness of the site
- A desirable space to recreate, socialise and enjoy multiple opportunities.
- Unique experience along the Brisbane Riverfront.
- Increased economic growth on-site and in the surrounding area.
- Activities for all user groups and backgrounds.
- Brisbane emerges as a new world city and improves tourism.
- The historic site is celebrated and embraced by many.

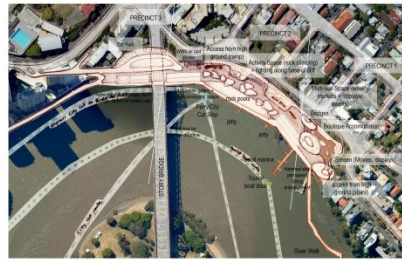

International Society of City and Regional Planners | ISOCARP



**ISOCARP**  
Knowledge for better Cities

## SCENARIO 2. OXLEY WHARVES

Relish. Remember. Relax.

Yuri Torres, Evgenia Kolesova, Inês Moreira, Jemima Hutch, Sophie Lam, Atil Chohan, Holly Williams

### VISION



Oxley Wharves will be a vibrant and well connected place of transition between the city and the suburbs. It will celebrate the historical, environmental and physical features of the site. Oxley Wharves will support the city to function as part of an open space network, an economic driver and as a place for the people. It will be a tribute to the river, its value and its potential.

- Ensure a balance between core project elements: people, economy, heritage and environment, while being sensitive to site features and constraints.
- Create a welcoming escape from the intensity of the city for the community and its visitors.

Embrace the river, the cliff and the site's heritage. Develop a niche economy that will contribute to the wider Brisbane economy. Connect people with places, spaces and facilities.

### CONCEPT

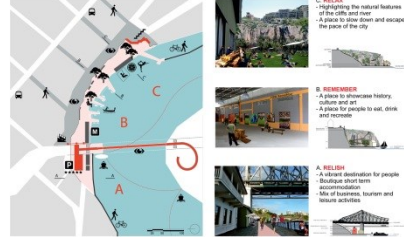

International Society of City and Regional Planners | ISOCARP



**ISOCARP**  
Knowledge for better Cities

### SCENARIO 3. THE WHARVES

Resilient, Flexible, Connected, Unique Identity, Inclusive

Jessica Carmichael, Peter Gazik, Meredith Harigan, Melissa Murphy, Caitlin Pozzi, Ekaterina Starnobutseva



The Wharves embraces responsive subtropical design to create a resilient and connected inner city urban environment. With a unique identity emerging from the site's industrial history and riverside location, 'The Wharves' is inclusive and provides flexible, multi-purpose spaces for residents and visitors alike.

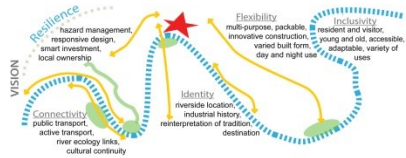

International Society of City and Regional Planners | ISOCARP



**ISOCARP**  
Knowledge for better Cities

### SCENARIO 4. HSW ECOTONE

Bridging history by connecting our river city icons

Bij Bojia, Luis Garrido, Kat McAuley, Tristen Miles, Daniele Vettorato, Anna Vladimirova

VISION  
AND  
STRATEGIES



The concept of 'ecotone' has informed our vision for the Howard Smith Wharves. An ecotone is a place in transition - where adjacent areas meet, integrate and create new community connections. Looking out over the river with the cliffs behind, the natural 'room' where environments meet creates a sense of comfort and containment - where historical icons like the Story Bridge meet the new landmark wharf precinct.

#### Past and Present - Connection 1



New buildings with historical bridge pylons and sheds; Children's recreation including a pool bringing families to a new area.

#### CBD and Residential - Connection 2



Walkways will create a scenic walk linking CBD and to New Farm end. Walkways can connect the site to the Riverwalk.

#### Upper and Lower - Connection 3



The 'Snail' spiral structure will accessibly connect the cliff tops to the riverbank and amphitheatre. The Snail will become an architectural landmark.

#### Land and Water - Connection 4



Tiered amphitheatre provides a connection between land and water. An existing shed will be a multi-purpose event space, capitalising on industrial history and river views.

#### CONCEPT - MASTER PLAN



International Society of City and Regional Planners | ISOCARP





# ISOCARP

Knowledge for better Cities

## CONCLUSIONS

Bringing together the ideas of the ISOCARP YPP 2013 workshop

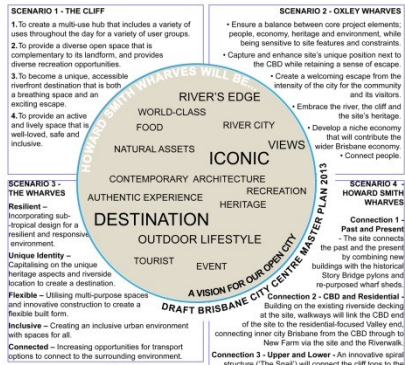

International Society of City and Regional Planners | ISOCARP

## YPP PHOTO REPORT

### WORKING DAYS







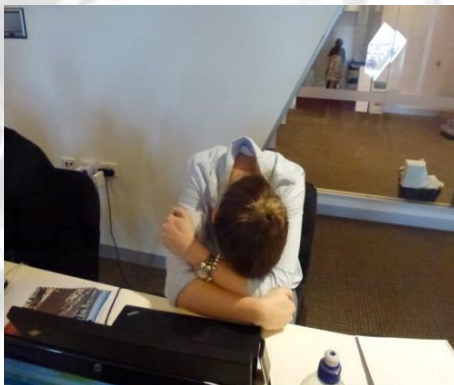





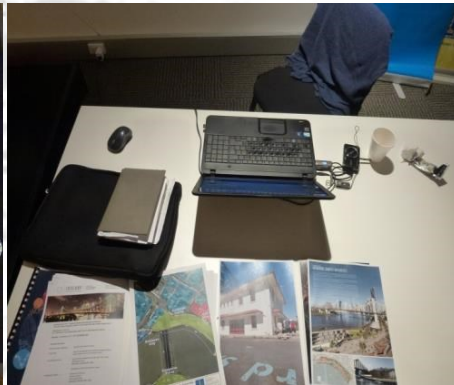



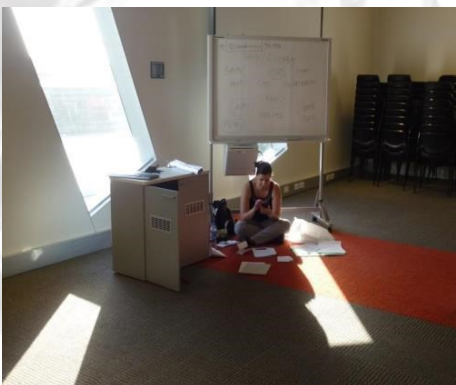
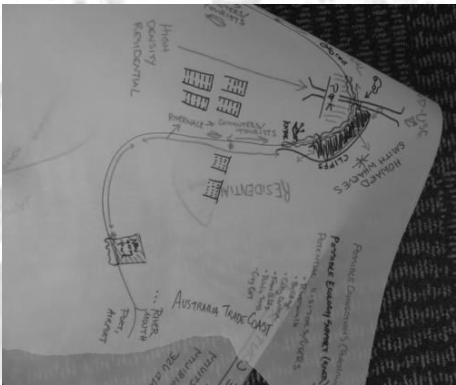

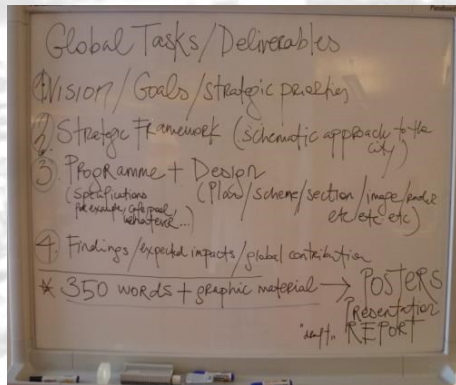



## AT THE CONGRESS

The workshop results were presented in the 49th ISOCARP congress at the brand new Royal International Convention Centre in Brisbane (www.ricc.com.au), 1-4 October 2013.

### THE OPENING PLENARY

(Picture available at: [http://www.isocarp.org/index.php?id=photos\\_and\\_video\\_ypp](http://www.isocarp.org/index.php?id=photos_and_video_ypp)).





AT THE EXHIBITION

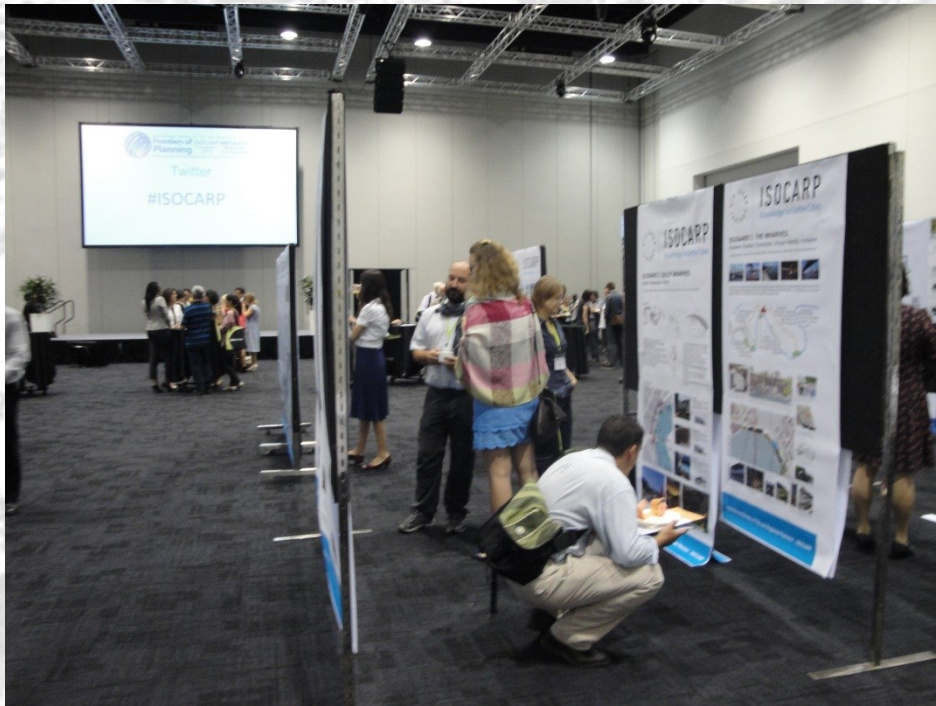



*THE GALA DINNER — CERTIFICATES AND AWARDS TO YPP'S*



*G'DAY MATES. CHEERS!*

