

DISCOVER CREATE PLACE HI STORY

GROUP 4: Hana, WU Miao, YAO Di, DENG Ziwen, GAN Wei, LIN Xiaodan



THE INNERCITY

5 DIFFERENT WORLDS

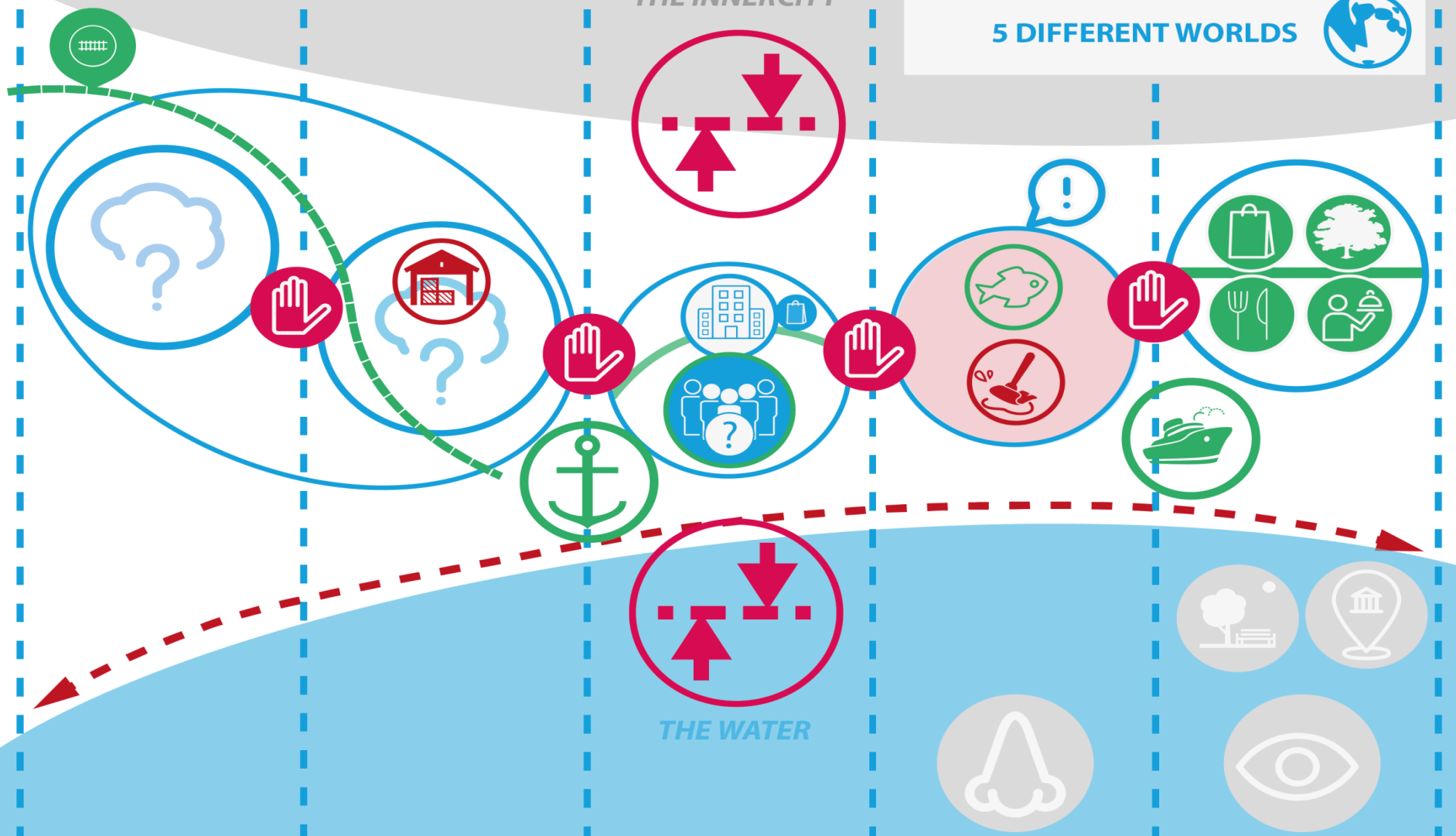



Green Spaces

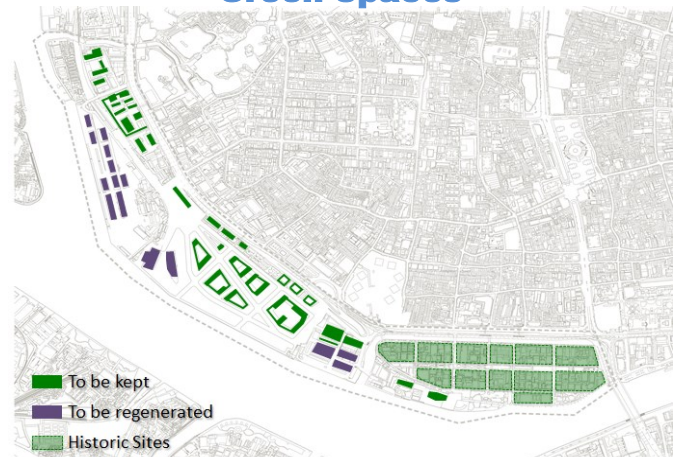

Buildings

- To be kept
- To be regenerated
- Historic Sites

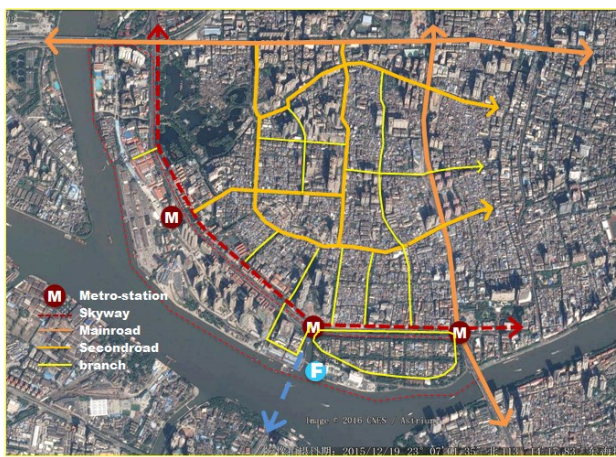

Traffic System



Hospitals

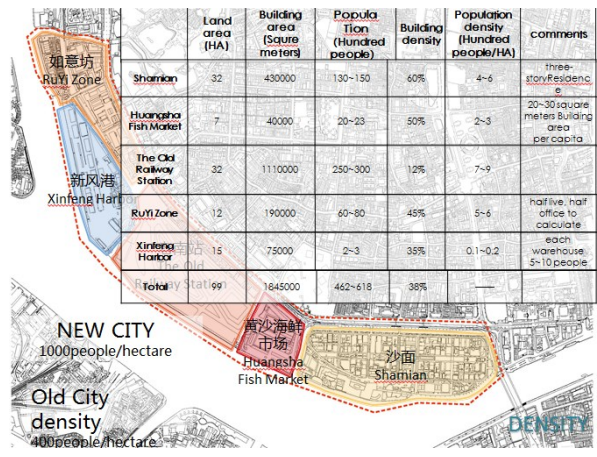

NEW CITY
1000people/hectare

Old City
density
400people/hectare

Project Fact



Schools



19



Lizhiwan

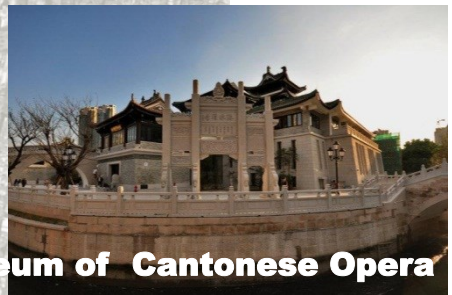

Museum of Cantonese Opera

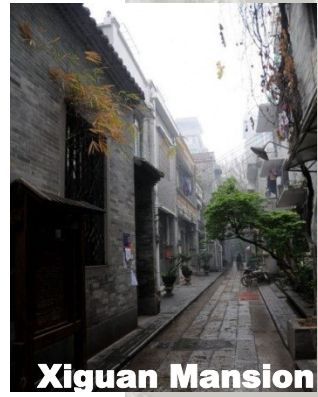

Xiguan Mansion

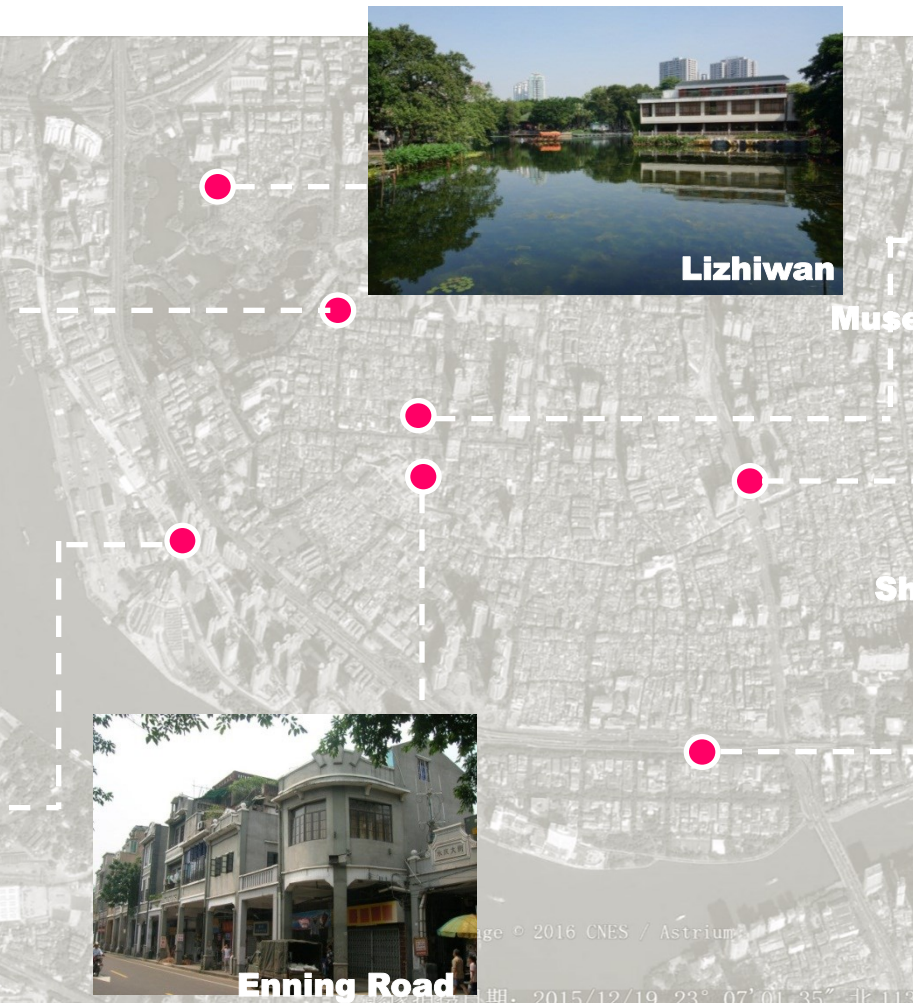

Shangxiajiu Walking Street

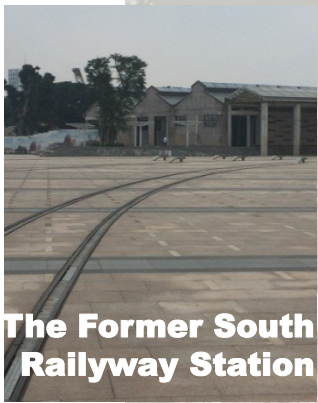

The Former South Railway Station

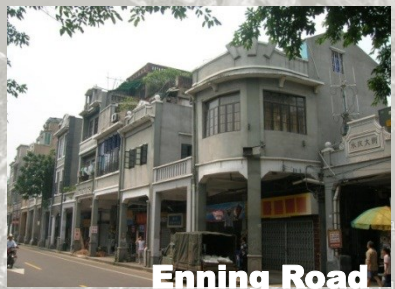

Enning Road



Shamian Area

Image © 2016 CNES / Astrium

影像拍摄日期: 2015/12/19 23° 07' 01.35" 北 113° 14' 17.83" 东海拔

Historic Resources



Memory

记忆 · 故事

Story

因水而生，
依水而盛



The City of GuangZhou is **alive** for the water, and **blossm** for the water



路线

广州

GUANG ZHOU

SITE





An aerial photograph of a city, likely Beijing, showing a dense urban grid. A specific area in the lower-left quadrant is highlighted with a red dashed line. This highlighted area contains several large, modern buildings and a significant amount of greenery. The rest of the city is shown in grayscale, with a high density of smaller buildings and streets. A large river or canal is visible on the left side of the image.

西关

XI GUAN

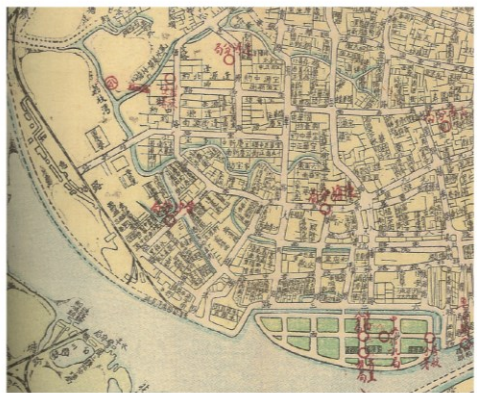
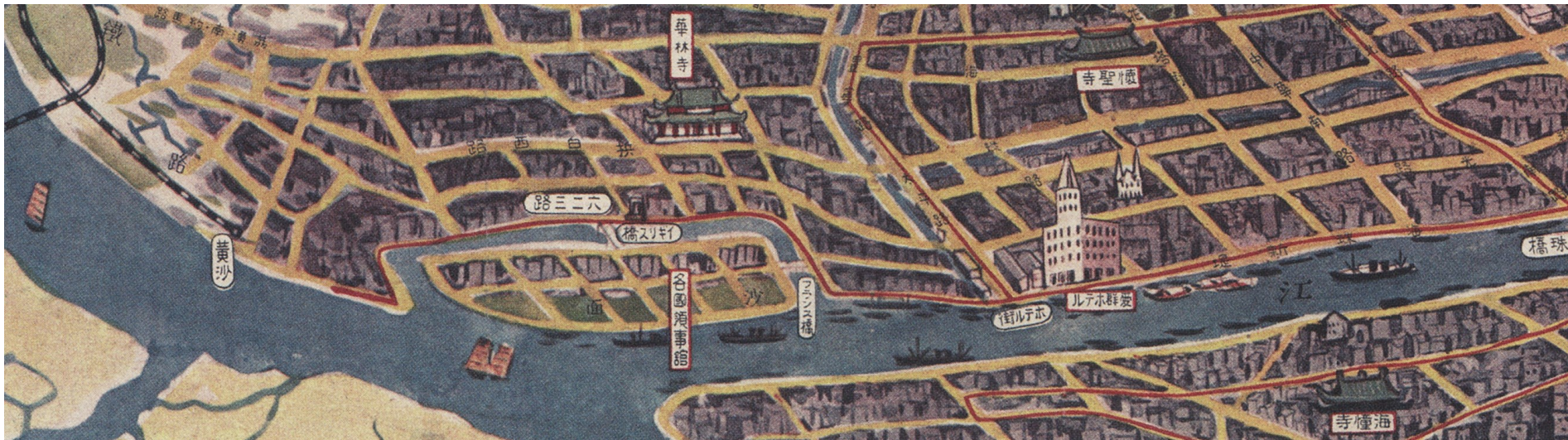

1900

1907

1937

1938



Fishman

渔民



Xinfeng Harbor

新风港口



Old station 广州南站

广州南站



Lizhi Bay

荔枝湾涌



Shameen

沙面

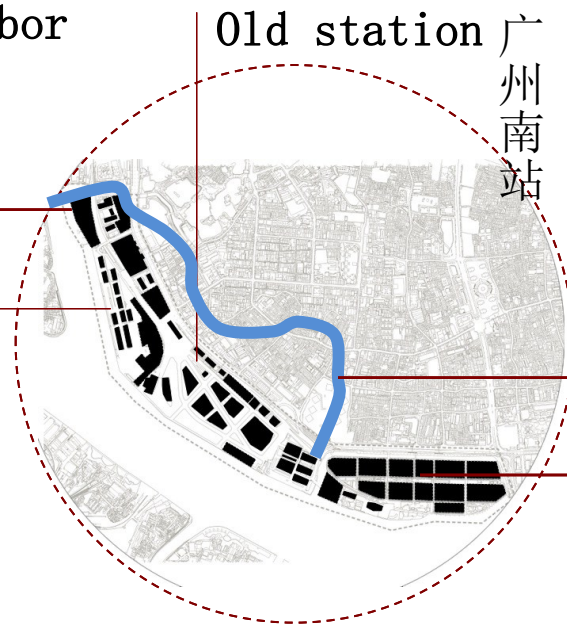

PLACES OF MEMORY

记忆场所

OLD FERRY
老码头地区

PORT AREA
港口

RAILWAY
火车站

FISH MARKET
鱼市

SHAMIAN
沙面街区

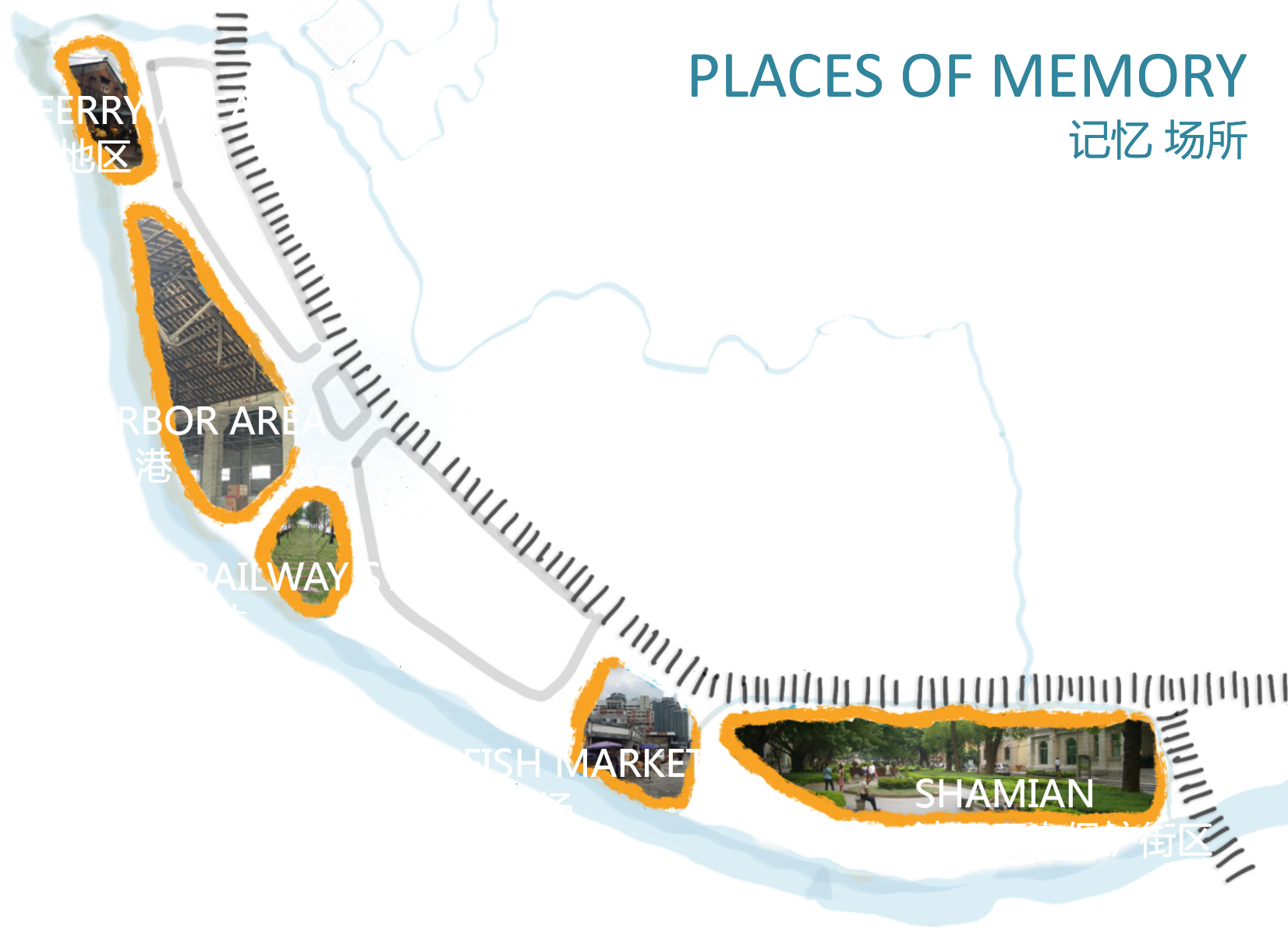

CONNECTIONS OF MEMEORY SITES 记忆场所的联系

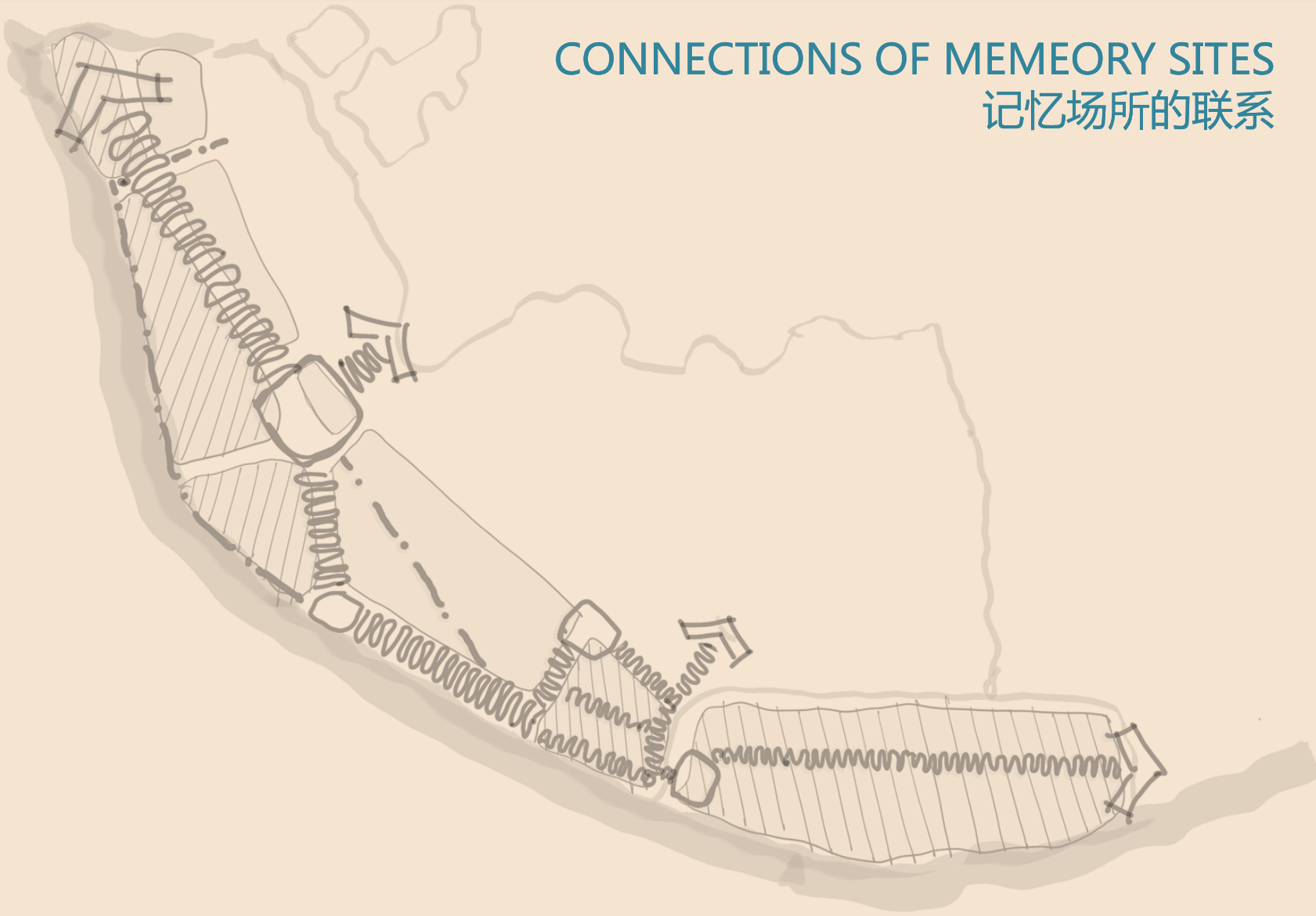

MEMORY VS IMAGINATION

记忆、场所、想象

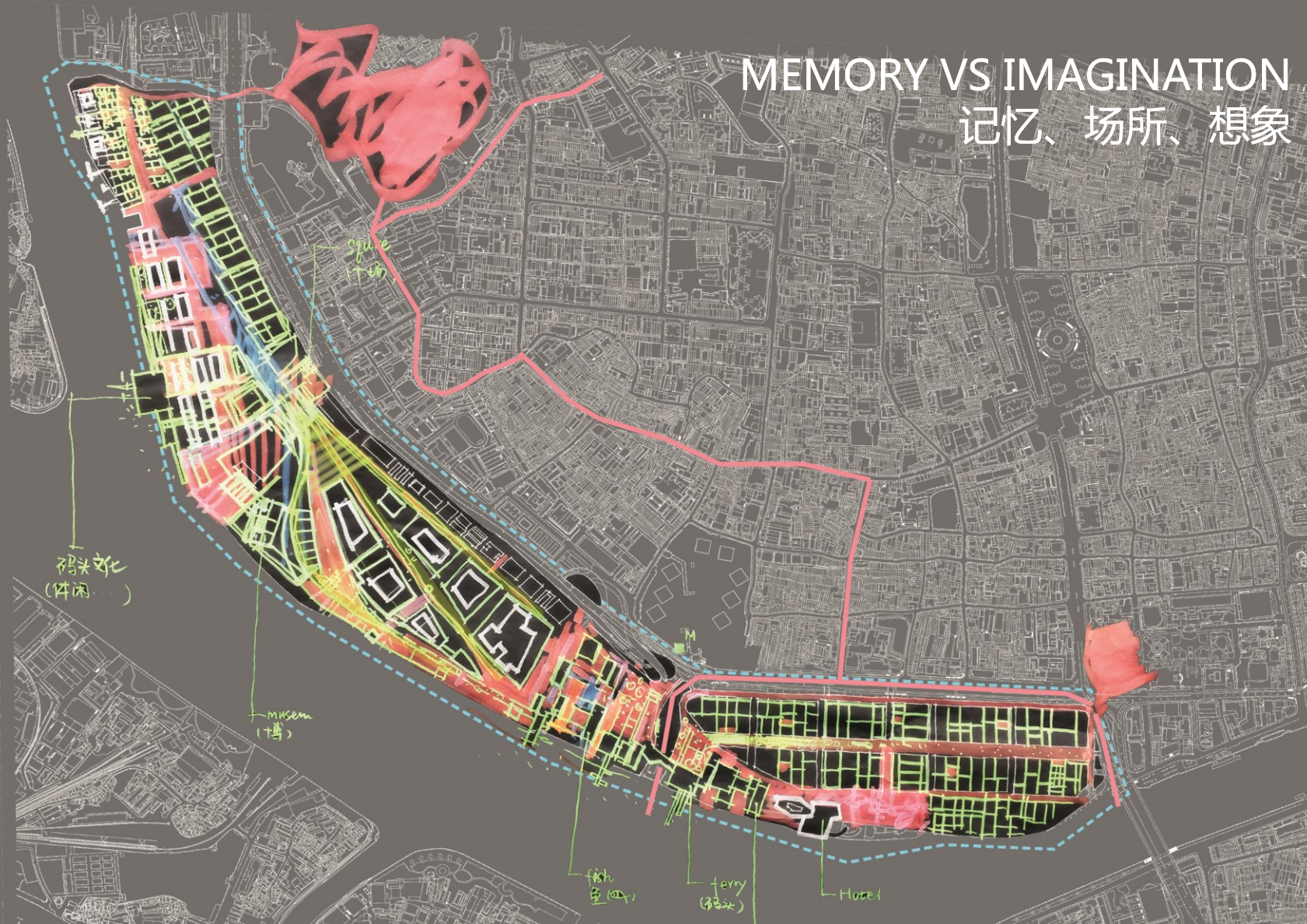

CONNECTIONS OF MEMEORY SITES 记忆场所的联系

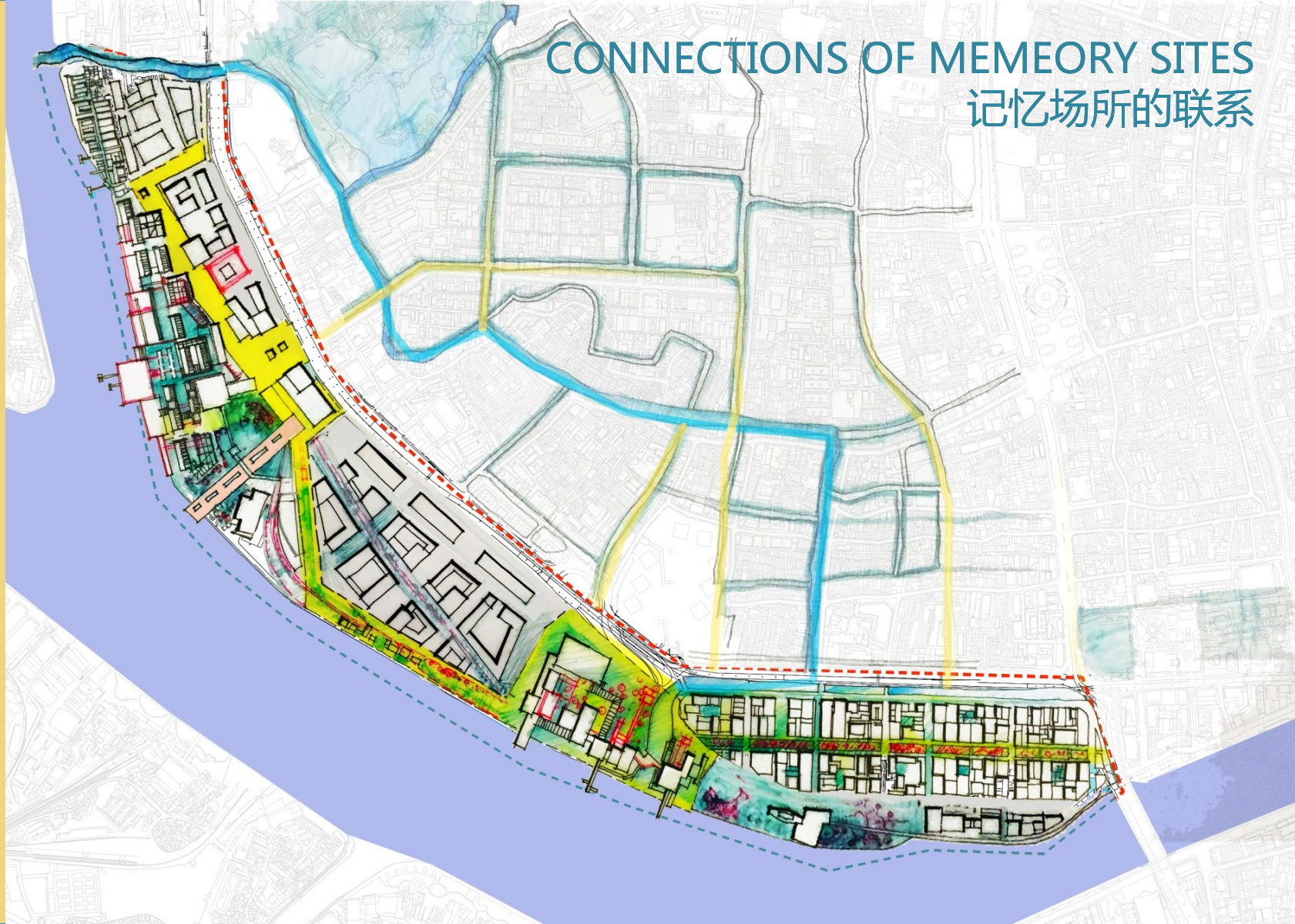









STORM

STARBUCKS



WROTE

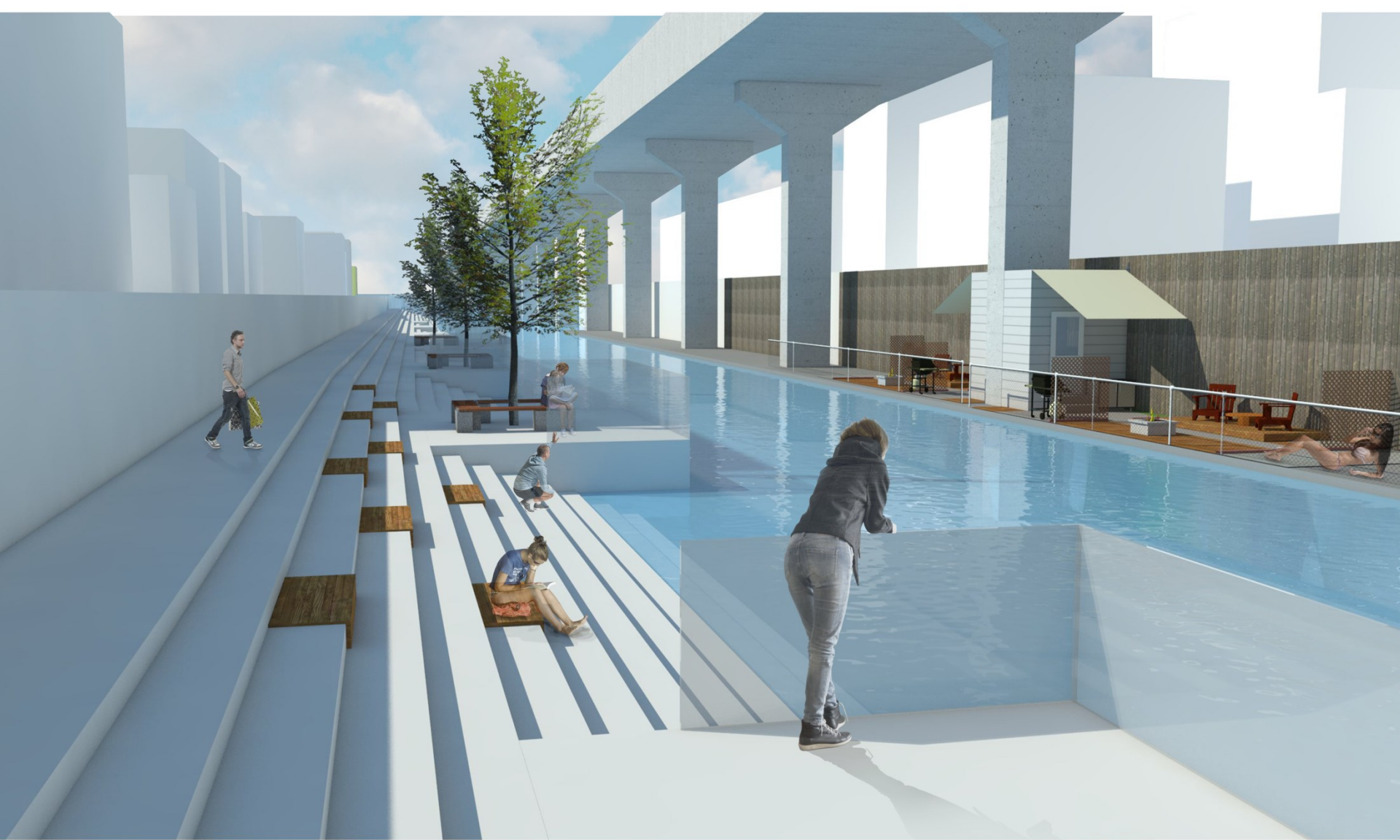

CONNECTIONS OF MEMEORY SITES

记忆场所的联系

YAO



LIN



WU



GAN



HANNA



DENG

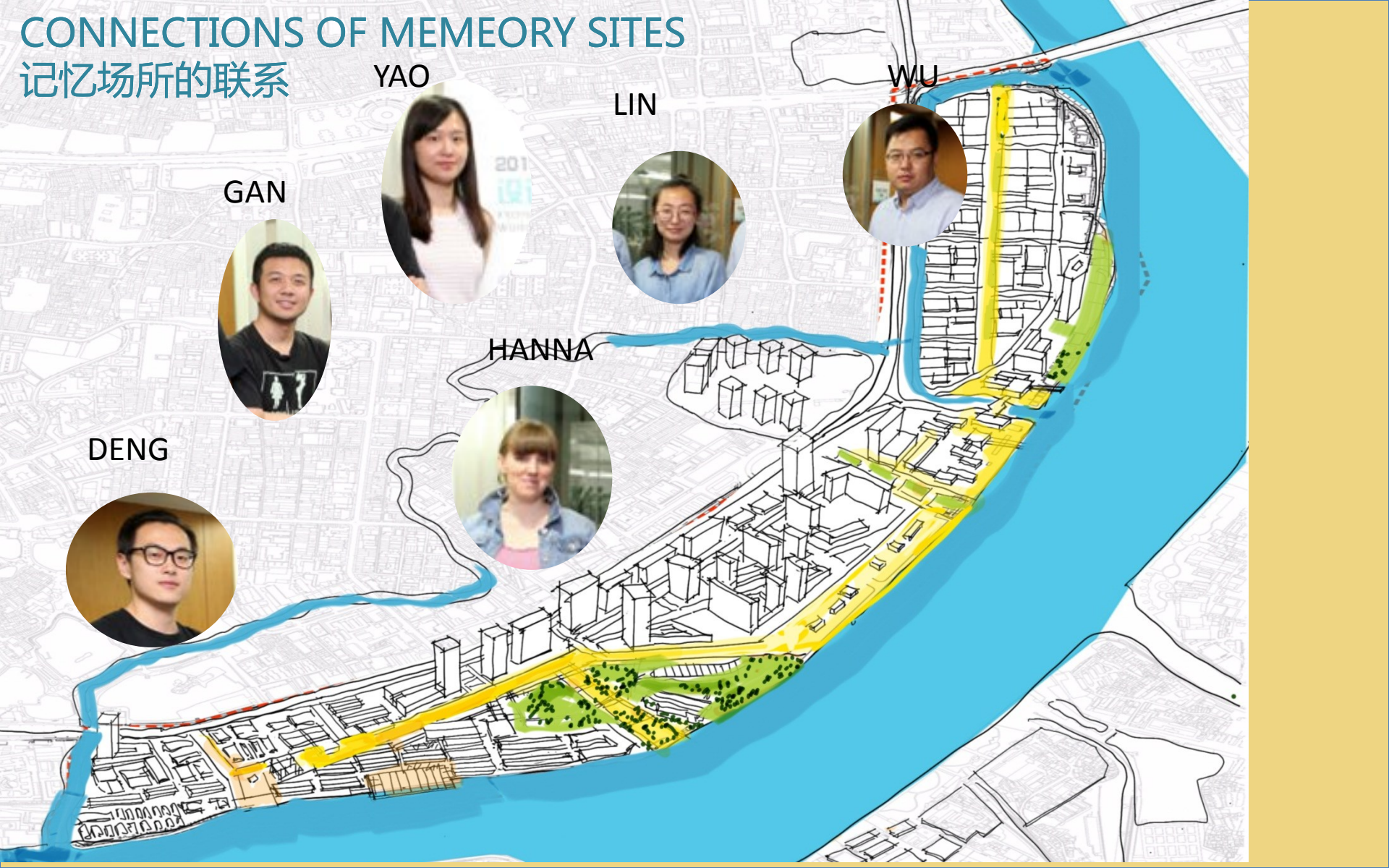

— 完 —

End